



sma



www.dynawave.com

dynawave
INCORPORATED

sma • interface dimensions

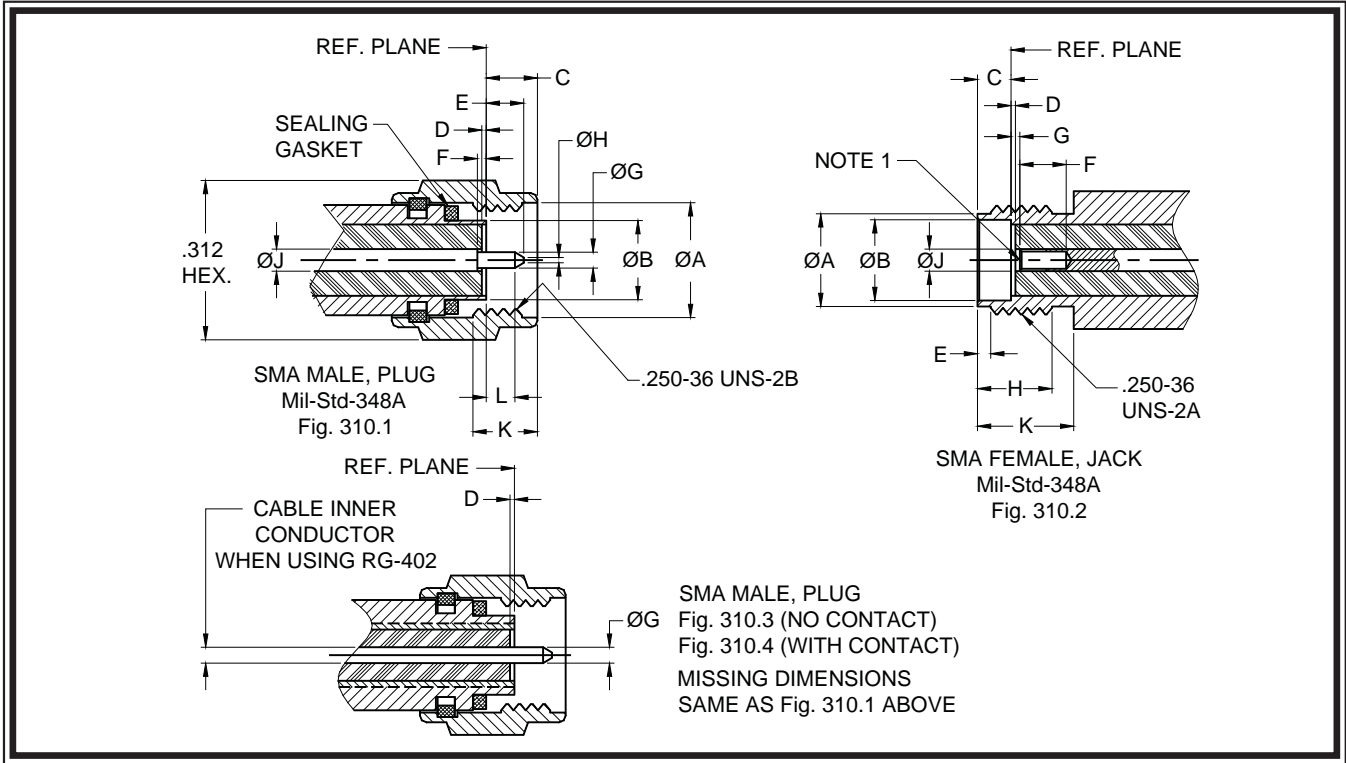

male, plug

female, jack

LTR.	INCHES/MILLIMETERS ³			
	MINIMUM		MAXIMUM	
	IN.	MM.	IN.	MM.
A	.250	6.35	-----	-----
B	-----	-----	.1808	4.59
C	-----	-----	.135	3.43
D*	.000	0.00	.010	0.25
E	-----	-----	.100	2.54
F**	.010	0.25	.000	0.00
G	.0355	0.90	.0370	0.94
H	-----	-----	.015	0.38
J	.049	1.24	.051	1.30
K	.130	3.30	-----	-----
L	.050	1.27	-----	-----

LTR.	INCHES / MILLIMETERS ³			
	MINIMUM		MAXIMUM	
	IN.	MM.	IN.	MM.
A	.208	5.28	.216	5.49
B	.1810	4.60	-----	-----
C	.074	1.88	.078	1.98
D*	.000	0.00	.010	0.25
E	.015	0.38	.045	1.14
F**	.115	2.92	-----	-----
G	.010	0.25	.000	0.00
H	.170	4.32	-----	-----
J	.049	1.24	.051	1.30
K	.218	5.54	-----	-----
L	-----	-----	-----	-----

* Dielectric Insulator Gap measured from connector body reference plane.000 inches maximum above (flush) to .010 inches maximum below.

**Center Contact Gap measured from connector body reference plane .000 inches maximum above (flush) to .010 maximum below.

Notes:

1. I.D. to meet VSWR and contact resistance when mated with .0370 / .0355 Dia. inches (0.94 / 0.90) Dia. millimeter pin.
2. When fully engaged, the two reference planes must coincide with metal-to-metal contact.
3. Metric equivalents (to the nearest 0.01mm) are given to general information only and are based on 1.0 millimeter=.03937 inchs.
4. These dimensions are subject to change according to the latest revisions of MIL-C-39012 and MIL-STD-348A.

sma specifications

The specifications below are general specifications for all SMA connectors. Specific specifications for VSWR, insertion loss and R.F. leakage for each connector is available from Dynawave upon request. Specifications in the following table are recommended for any procurement documents or drawings

In the event of any conflict between these specifications and General Specification MIL-C-39012 these specifications shall govern. These specifications are subject to change according to the latest revision of MIL-C-39012.

REQUIREMENT	MIL-C-39012 PARAGRAPH	SPECIFICATIONS
GENERAL		
Material	3.3	Steel corrosion resistant per ASTM- A- 581, Type 303, Cond. A Beryllium copper per ASTM-B196/B, 196M Copper Alloy TFE Fluorocarbon per ASTM-D-1710, Type 1, Grade 1, Class B. Silicone Rubber per ZZ-R-765, CLASS IIB. 50-60 Shore.
Finish	3.3.1	Center contacts shall be gold plated to a minimum thickness of .00005-inch in accordance with ATSM-B-488, Type I, Code C. All other metal parts shall be finished so as to provide a connector which meets the corrosion requirements of this table.
Design	3.4	The design shall be such that the outline dimensions in this catalog are met. In addition the assembled connector shall meet the interface dimensions.
ELECTRICAL		
Insulation Resistance	3.11	The insulation resistance shall not be less than 5,000 megohms
Dielectric Withstanding Voltage	3.17	The magnitude of the test voltage shall be 1,000 volts rms at sea level
RF High Potential Withstanding Voltage	3.23	The RF high potential withstanding voltage is 670 volts rms at 5 MHz. Leakage is not applicable.
Contact Resistance	3.18	The center contact resistance drop shall not exceed 3.0 milliohms and the outer contact resistance drop shall not exceed 2.0 milliohms.
Voltage Standing Wave Ratio (VSWR)	3.14	See applicable connector specifications.
RF Leakage	3.26	See applicable connector specifications.
Insertion Loss	3.27	See applicable connector specification.
MECHANICAL		
Force to Engage and Disengage inch-pounds.	3.5.1	The torque required to engage and disengage shall not exceed 2 The longitudinal force is not applicable
Coupling Nut Retention Force is and Proof Torque.	3.25	Not applicable for Female connectors. For Male connectors, the retention force 100 pounds minimum. The Proof torque is 15 inch-pounds minimum.
Cable Retention force requirements shall not apply.	3.24	The force applied shall be 60 pounds minimum. The cable twisting and bending
Mating Characteristics size	3.7	See interface dimensions shown on Page 10. Applicable to Females only: over-pin .0372 minimum diameter .045 deep; Insertion force 3 pounds maximum with .0375 minimum diameter pin; withdrawal force 1 ounce minimum with .0355 maximum diameter pin.
Connector Durability	3.15	The connector to be tested and its mating connector shall be subjected to 500 insertions and withdrawal cycles at 12 cycles per minute maximum. The connector shall show no evidence of mechanical failure and connector shall meet the mating characteristic requirements.
ENVIRONMENTAL		
Vibration	3.18	Specification MIL-STD-202, Method 204, Test Condition D.
Shock	3.19	Specification MIL-STD-202, Method 213, Test Condition I.
Thermal Shock	3.20	Specification MIL-STD-202, Method 107, Test Condition B except high temperature shall be + 200°C.
Recommended Mating Torque		7-10 inch-pounds
Corrosion (Salt Spray)	3.13	Specification MIL-STD-202, Method 101, Test Condition B. The salt solution shall be five per cent.
Moisture Resistance	3.21	Specification MIL-STD-202, Method 106. Step 7b (vibration) shall be omitted. Insulation resistance shall be 200 megohms minimum within 5 minutes of removal from humidity.
Corona Level	3.22	The connector shall not exhibit breakdown (corona) when the applied voltage is 250 volts rms and the altitude is 70,000 feet.
Complete specifications on every connector in this catalog are available from Dynawave		

Specifications are subject to change without notice

sma • semi rigid cable connectors

male, plug, straight, with center contact

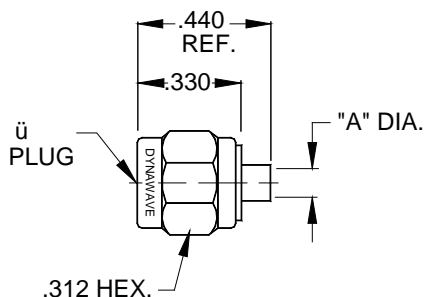

PART NUMBER	"A DIA."	CABLE TYPE	MATERIAL TYPE	FREQUENCY RANGE
9800-8520-2400	.089 MIN.	RG 405/U (.085)	BRASS	DC - 26.5 GHz.
9800-4120-2401	.144 MIN.	RG 402/U (.141)	BRASS	DC - 26.5 GHz.
9800-8520-6246	.089 MIN.	RG 405/U (.085)	STAINLESS STEEL	DC - 26.5 GHz.
9800-4120-6244	.144 MIN.	RG 402/U (.141)	STAINLESS STEEL	DC - 26.5 GHz.
9800-8520-6446	.089 MIN.	RG 405/U (.085)	STAINLESS STEEL	DC - 26.5 GHz.
9800-4120-6444	.144 MIN.	RG 402/U (.141)	STAINLESS STEEL	DC - 26.5 GHz.

male, plug, straight, low profile with center contact

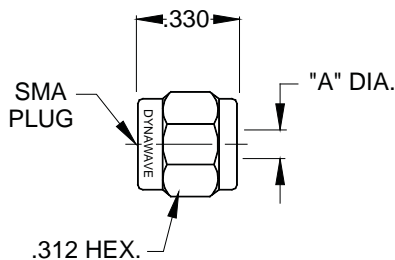

PART NUMBER	"A DIA."	CABLE TYPE	MATERIAL TYPE	FREQUENCY RANGE
9800-8520-6240	.089 MIN.	RG 405/U (.085)	STAINLESS STEEL	DC - 26.5 GHz.

male, plug, straight, low profile, without center contact

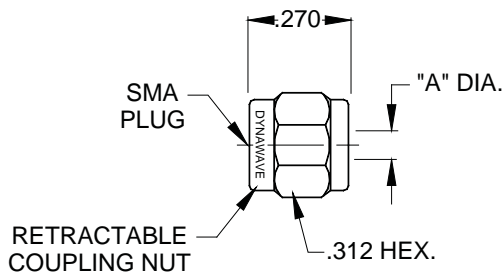

PART NUMBER	"A DIA."	CABLE TYPE	MATERIAL TYPE	FREQUENCY RANGE
9800-4426-6245	.144 MIN.	RG 402/U (.141)	STAINLESS STEEL	DC - 26.5 GHz.
9800-4426-6243	.144 MIN.	RG 402/U (.141)	STAINLESS STEEL	DC - 26.5 GHz.
9800-4426-6443	.144 MIN.	RG 402/U (.141)	STAINLESS STEEL	DC - 26.5 GHz.

sma • semi rigid cable connectors

male, plug, straight, anti-torque, with center contact

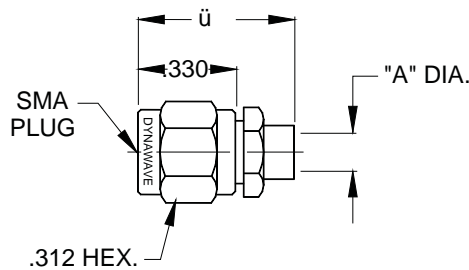

PART NUMBER	"A DIA."	CABLE TYPE	MATERIAL TYPE	FREQUENCY RANGE
9800-9086-6244	.089 MIN.	RG 405/U (.085)	STAINLESS STEEL	DC - 26.5 GHz.
9800-9086-6444	.089 MIN.	RG 405/U (.085)	STAINLESS STEEL	DC - 26.5 GHz.
9800-9141-6244	.144 MIN.	RG 402/U (.141)	STAINLESS STEEL	DC - 26.5 GHz.
9800-9141-6444	.144 MIN.	RG 402/U (.141)	STAINLESS STEEL	DC - 26.5 GHz.

male, plug, straight, anti-torque, without center contact

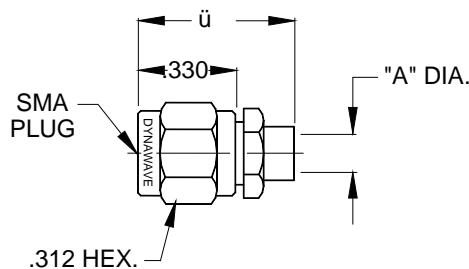

PART NUMBER	"A DIA."	CABLE TYPE	MATERIAL TYPE	FREQUENCY RANGE
9800-9141-6240	.144 MIN.	RG 402/U (.141)	STAINLESS STEEL	DC - 26.5 GHz.
9800-9141-6440	.144 MIN.	RG 402/U (.141)	STAINLESS STEEL	DC - 26.5 GHz.

female, jack, straight

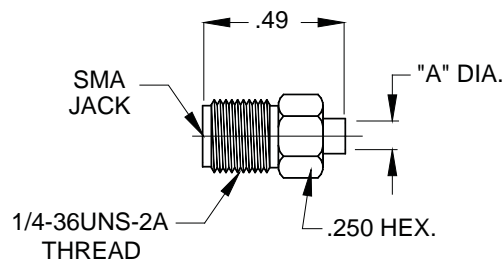

PART NUMBER	"A DIA."	CABLE TYPE	MATERIAL TYPE	FREQUENCY RANGE
9900-4721-6400	.052 MIN.	.047 SEMI-RIGID	STAINLESS STEEL	DC - 26.5 GHz.
9900-8520-6401	.089 MIN.	RG 405/U (.085)	STAINLESS STEEL	DC - 26.5 GHz.
9900-4120-6444	.144 MIN.	RG 402/U (.141)	STAINLESS STEEL	DC - 26.5 GHz.

Specifications are subject to change without notice

sma • semi rigid cable connectors

female, jack, bulkhead mount

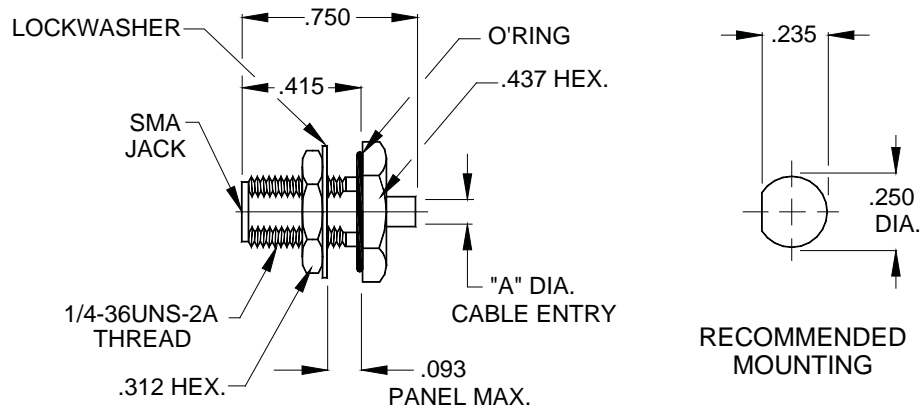

PART NUMBER	"A DIA."	CABLE TYPE	MATERIAL TYPE	FREQUENCY RANGE
9910-4720-6403	.052 MIN.	.047 SEMI-RIGID	STAINLESS STEEL	DC - 26.5 GHz.
9910-8520-6403	.089 MIN.	RG 405/U (.085)	STAINLESS STEEL	DC - 26.5 GHz.
9910-4120-6403	.144 MIN.	RG 402/U (.141)	STAINLESS STEEL	DC - 26.5 GHz.

female, jack, bulkhead mount

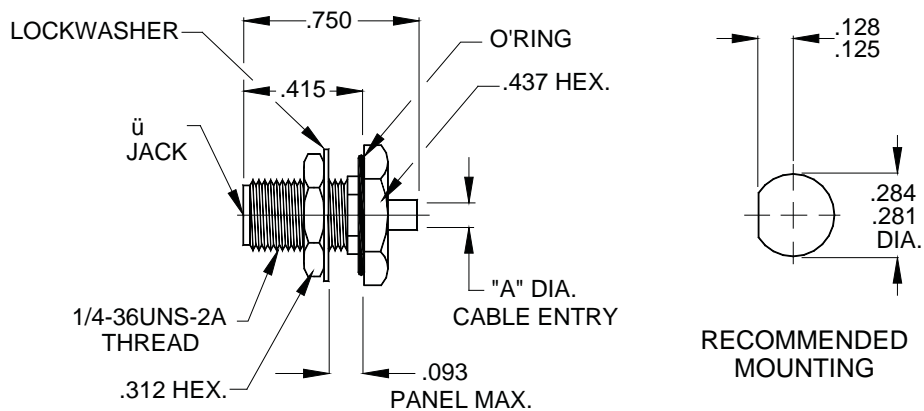

PART NUMBER	"A DIA."	CABLE TYPE	MATERIAL TYPE	FREQUENCY RANGE
9910-4720-6401	.052 MIN.	.047 SEMI-RIGID	STAINLESS STEEL	DC - 26.5 GHz.
9910-8520-6401	.089 MIN.	RG 405/U (.085)	STAINLESS STEEL	DC - 26.5 GHz.
9910-4120-6401	.144 MIN.	RG 402/U (.141)	STAINLESS STEEL	DC - 26.5 GHz.

Specifications are subject to change without notice

sma • semi rigid cable connectors

female, jack, flange mount, captured contact

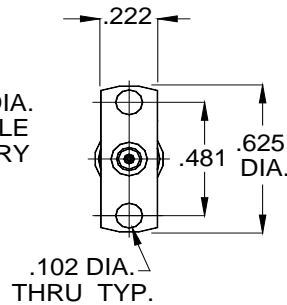
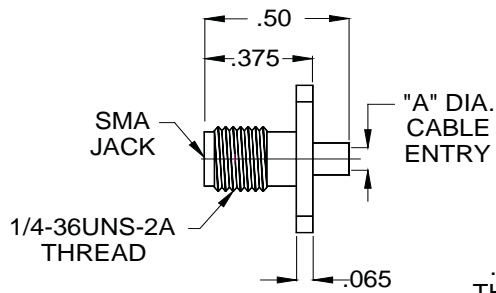

Fig. 1

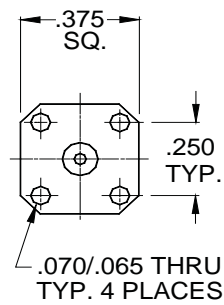

Fig. 2

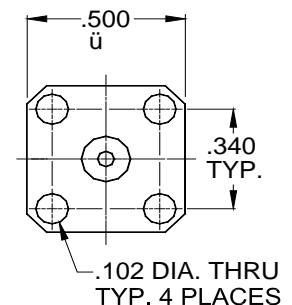

Fig. 3

PART NUMBER	Fig.	"A DIA."	CABLE TYPE	MATERIAL TYPE	FREQUENCY RAN
9952-4721-2400	1	.052 MIN.	.047 SEMI-RIGID	BRASS	DC - 26.5 GHz.
9952-4721-6401	1	.052 MIN.	.047 SEMI-RIGID	STAINLESS STEEL	DC - 26.5 GHz.
9952-8521-2440	1	.089 MIN.	RG 405/U (.085)	BRASS	DC - 26.5 GHz.
9952-8521-6440	1	.089 MIN.	RG 405/U (.085)	STAINLESS STEEL	DC - 26.5 GHz.
9952-4121-2400	1	.144 MIN.	RG 402/U (.141)	BRASS	DC - 26.5 GHz.
9952-4121-6400	1	.144 MIN.	RG 402/U (.141)	STAINLESS STEEL	DC - 26.5 GHz.
9954-4721-2401	2	.052 MIN.	.047 SEMI-RIGID	BRASS	DC - 26.5 GHz.
9954-4721-6401	2	.052 MIN.	.047 SEMI-RIGID	STAINLESS STEEL	DC - 26.5 GHz.
9954-8521-2441	2	.089 MIN.	RG 405/U (.085)	BRASS	DC - 26.5 GHz.
9954-8521-6441	2	.089 MIN.	RG 405/U (.085)	STAINLESS STEEL	DC - 26.5 GHz.
9954-4121-2401	2	.144 MIN.	RG 402/U (.141)	BRASS	DC - 26.5 GHz.
9954-4121-6401	2	.144 MIN.	RG 402/U (.141)	STAINLESS STEEL	DC - 26.5 GHz.
9954-4721-2402	3	.052 MIN.	.047 SEMI-RIGID	BRASS	DC - 26.5 GHz.
9954-4721-6400	3	.052 MIN.	.047 SEMI-RIGID	STAINLESS STEEL	DC - 26.5 GHz.
9954-8521-2442	3	.089 MIN.	RG 405/U (.085)	BRASS	DC - 26.5 GHz.
9954-8521-6400	3	.089 MIN.	RG 405/U (.085)	STAINLESS STEEL	DC - 26.5 GHz.
9954-4121-2402	3	.144 MIN.	RG 402/U (.141)	BRASS	DC - 26.5 GHz.
9954-4121-6400	3	.144 MIN.	RG 402/U (.141)	STAINLESS STEEL	DC - 26.5 GHz.

Specifications are subject to change without notice

sma • semi rigid cable connectors

male, plug, right angle

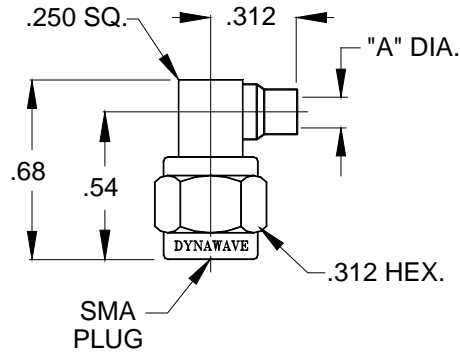

PART NUMBER	"A DIA."	CABLE TYPE	MATERIAL TYPE	FREQUENCY RANGE
9801-8520-2401	.089 MIN.	RG 405/U (.085)	BRASS	DC - 12.5 GHz.
9801-8521-6212	.089 MIN.	RG 405/U (.085)	STAINLESS STEEL	DC - 12.5 GHz.
9801-4120-2400	.144 MIN.	RG 402/U (.141)	BRASS	DC - 12.5 GHz.
9801-4121-6212	.144 MIN.	RG 402/U (.141)	STAINLESS STEEL	DC - 12.5 GHz.

male, plug, right angle, solder clamp

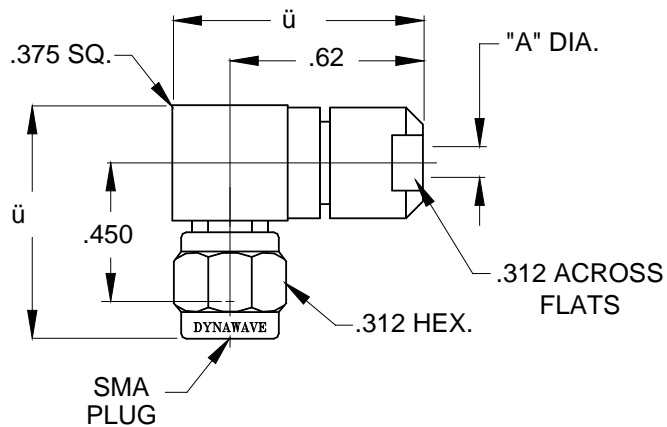

PART NUMBER	"A DIA."	CABLE TYPE	MATERIAL TYPE	FREQUENCY RANGE
9801-8540-6200	.089 MIN.	RG 405/U (.085)	STAINLESS STEEL	DC - 18.0 GHz.
9801-4140-6200	.144 MIN.	RG 402/U (.141)	STAINLESS STEEL	DC - 18.0 GHz.

Specifications are subject to change without notice

sma • flexible cable connectors

male, plug, straight, crimp attachment
rg 174/u, 179, 187, 188, 316

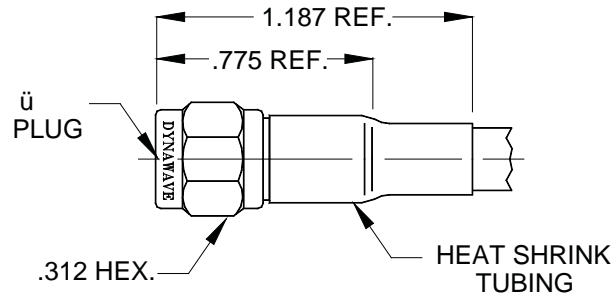

PART NUMBER	MATERIAL TYPE	FREQUENCY RANGE
9800-1630-2301	BRASS	DC - 3.0 GHz.
9800-1630-6200	STAINLESS STEEL	DC - 3.0 GHz.

male, plug, straight, crimp attachment
rg 316 double braid

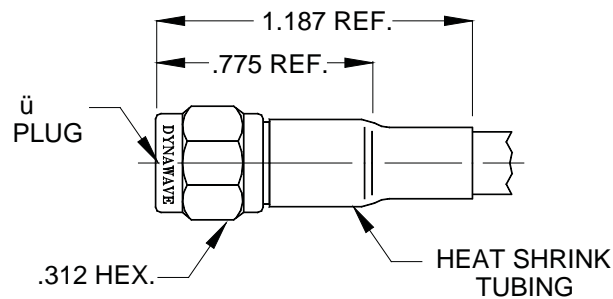

PART NUMBER	MATERIAL TYPE	FREQUENCY RANGE
9800-1830-2300	BRASS	DC - 12.4 GHz.
9800-1830-6200	STAINLESS STEEL	DC - 12.4 GHz.

male, plug, straight, crimp attachment
rg 58/u, 142, 223, 400

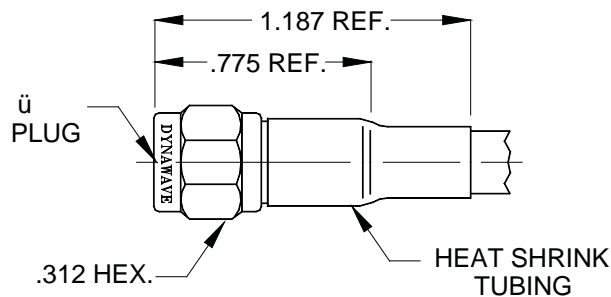

PART NUMBER	MATERIAL TYPE	FREQUENCY RANGE
9800-4230-2300	BRASS	DC - 12.4 GHz.
9800-4230-6441	STAINLESS STEEL	DC - 12.4 GHz.

sma • flexible cable connectors

male, plug, right angle, crimp attachment
rg 174/u, 179, 187, 188, 316

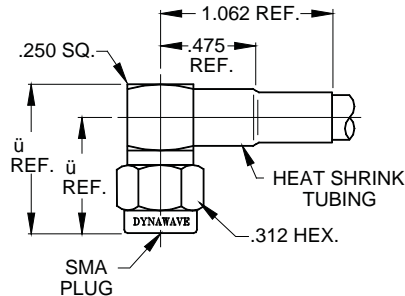

PART NUMBER	MATERIAL TYPE	FREQUENCY RANGE
9801-1630-2400	BRASS	DC - 3.0 GHz.
9801-1630-6440	STAINLESS STEEL	DC - 3.0 GHz.

male, plug, right angle, crimp attachment
rg 316 double braid

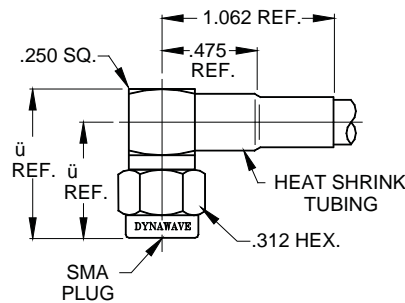

PART NUMBER	MATERIAL TYPE	FREQUENCY RANGE
9801-1830-2400	BRASS	DC - 12.4 GHz.
9801-1830-6200	STAINLESS STEEL	DC - 12.4 GHz.

male, plug, right angle, crimp attachment
rg 58/u, 142, 223, 400

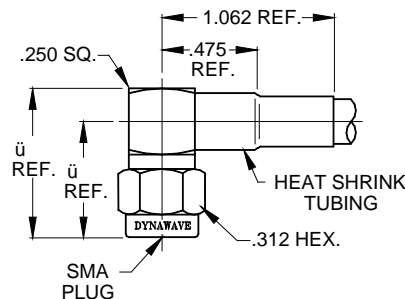

PART NUMBER	MATERIAL TYPE	FREQUENCY RANGE
9801-4230-2300	BRASS	DC - 12.4 GHz.
9801-4230-6200	STAINLESS STEEL	DC - 12.4GHz.

sma • field replaceable connectors

female, jack, 2 hole flange mount

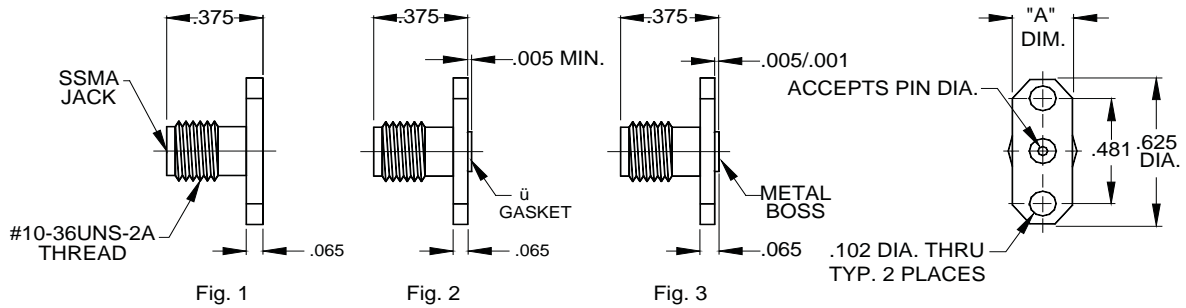

PART NUMBER	Fig.	ACCEPTS PIN DIA.	"A" DIM.	MATERIAL TYPE	FREQUENCY RANGE
9952-0081-6215	1	.016/.011	.222	STAINLESS STEEL	DC - 26.5 GHz.
9952-0781-6215	2	.016/.011	.222	STAINLESS STEEL	DC - 26.5 GHz.
9952-0881-6215	3	.016/.011	.222	STAINLESS STEEL	DC - 26.5 GHz.
9952-0081-6220	1	.021/.017	.222	STAINLESS STEEL	DC - 26.5 GHz.
9952-0781-6220	2	.021/.017	.222	STAINLESS STEEL	DC - 26.5 GHz.
9952-0881-6220	3	.021/.017	.222	STAINLESS STEEL	DC - 26.5 GHz.
9952-0081-6236	1	.037/.035	.222	STAINLESS STEEL	DC - 26.5 GHz.
9952-0781-6236	2	.037/.035	.300	STAINLESS STEEL	DC - 26.5 GHz.
9952-0881-6236	3	.037/.035	.260	STAINLESS STEEL	DC - 26.5 GHz.

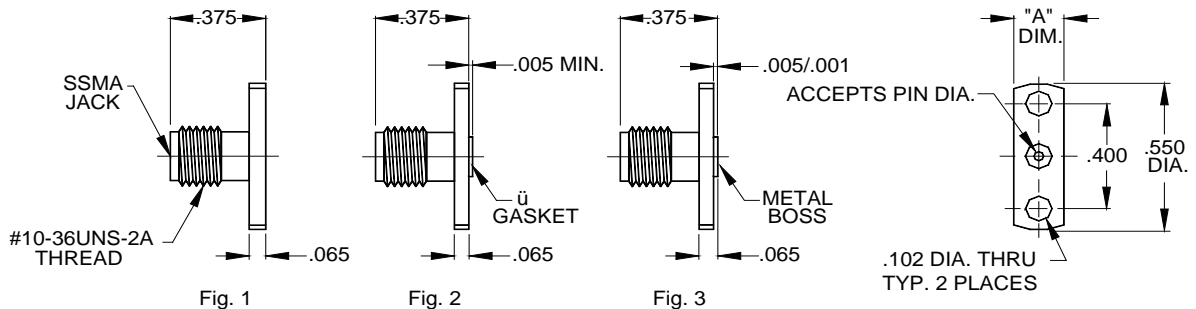

PART NUMBER	Fig.	ACCEPTS PIN DIA.	"A" DIM.	MATERIAL TYPE	FREQUENCY RANGE
9952-0081-6214	1	.016/.011	.190	STAINLESS STEEL	DC - 26.5 GHz.
9952-0781-6214	2	.016/.011	.190	STAINLESS STEEL	DC - 26.5 GHz.
9952-0881-6214	3	.016/.011	.190	STAINLESS STEEL	DC - 26.5 GHz.
9952-0081-6224	1	.021/.017	.190	STAINLESS STEEL	DC - 26.5 GHz.
9952-0781-6224	2	.021/.017	.190	STAINLESS STEEL	DC - 26.5 GHz.
9952-0881-6224	3	.021/.017	.190	STAINLESS STEEL	DC - 26.5 GHz.
9952-0081-6246	1	.037/.035	.190	STAINLESS STEEL	DC - 26.5 GHz.
9952-0781-6246	2	.037/.035	.300	STAINLESS STEEL	DC - 26.5 GHz.
9952-0881-6246	3	.037/.035	.260	STAINLESS STEEL	DC - 26.5 GHz.

Specifications are subject to change without notice

sma • field replaceable connectors

female, jack, 2 hole flange mount

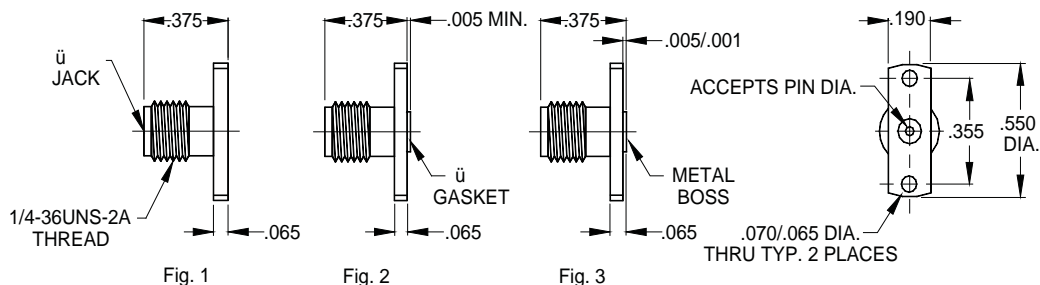

PART NUMBER	Fig.	ACCEPTS PIN DIA	MATERIAL TYPE	FREQUENCY RANGE
9952-0081-6213	1	.016/.011	STAINLESS STEEL	DC - 26.5 GHz.
9952-0781-6213	2	.016/.011	STAINLESS STEEL	DC - 26.5 GHz.
9952-0881-6225	3	.016/.011	STAINLESS STEEL	DC - 26.5 GHz.
9952-0081-6223	1	.021/.017	STAINLESS STEEL	DC - 26.5 GHz.
9952-0781-6223	2	.021/.017	STAINLESS STEEL	DC - 26.5 GHz.
9952-0881-6222	3	.021/.017	STAINLESS STEEL	DC - 26.5 GHz.

female, jack, 4 hole flange mount

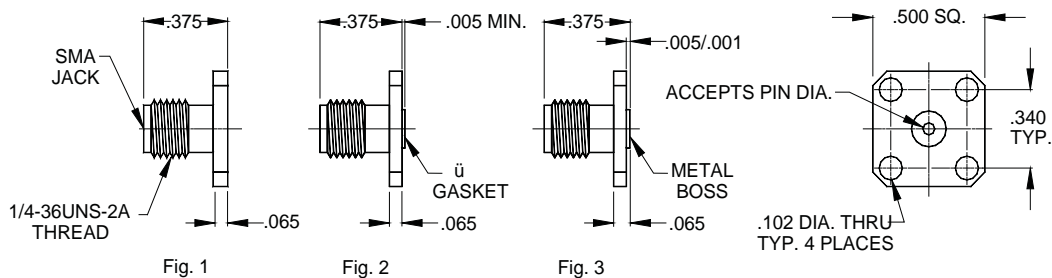

PART NUMBER	Fig.	ACCEPTS PIN DIA	MATERIAL TYPE	FREQUENCY RANGE
9954-0081-6215	1	.016/.011	STAINLESS STEEL	DC - 26.5 GHz.
9954-0781-6215	2	.016/.011	STAINLESS STEEL	DC - 26.5 GHz.
9954-0881-6215	3	.016/.011	STAINLESS STEEL	DC - 26.5 GHz.
9954-0081-6220	1	.021/.017	STAINLESS STEEL	DC - 26.5 GHz.
9954-0781-6220	2	.021/.017	STAINLESS STEEL	DC - 26.5 GHz.
9954-0881-6220	3	.021/.017	STAINLESS STEEL	DC - 26.5 GHz.
9954-0081-6236	1	.037/.035	STAINLESS STEEL	DC - 26.5 GHz.
9954-0781-6236	2	.037/.035	STAINLESS STEEL	DC - 26.5 GHz.
9954-0881-6236	3	.037/.035	STAINLESS STEEL	DC - 26.5 GHz.

sma • field replaceable connectors

female, jack, 4 hole flange mount

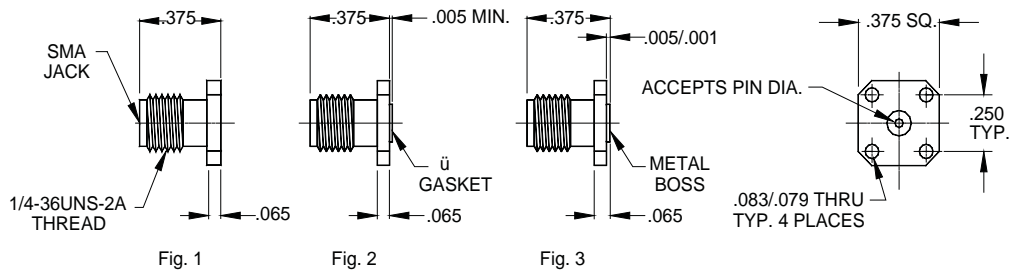

PART NUMBER	Fig.	ACCEPTS PIN DIA	MATERIAL TYPE	FREQUENCY RANGE
9954-0081-6217	1	.016/.011	STAINLESS STEEL	DC - 26.5 GHz.
9954-0781-6217	2	.016/.011	STAINLESS STEEL	DC - 26.5 GHz.
9954-0881-6217	3	.016/.011	STAINLESS STEEL	DC - 26.5 GHz.
9954-0081-6227	1	.021/.017	STAINLESS STEEL	DC - 26.5 GHz.
9954-0781-6227	2	.021/.017	STAINLESS STEEL	DC - 26.5 GHz.
9954-0881-6227	3	.021/.017	STAINLESS STEEL	DC - 26.5 GHz.
9954-0081-6237	1	.037/.035	STAINLESS STEEL	DC - 26.5 GHz.
9954-0781-6237	2	.037/.035	STAINLESS STEEL	DC - 26.5 GHz.
9954-0881-6237	3	.037/.035	STAINLESS STEEL	DC - 26.5 GHz.

female, jack, 4 hole rectangular flange mount

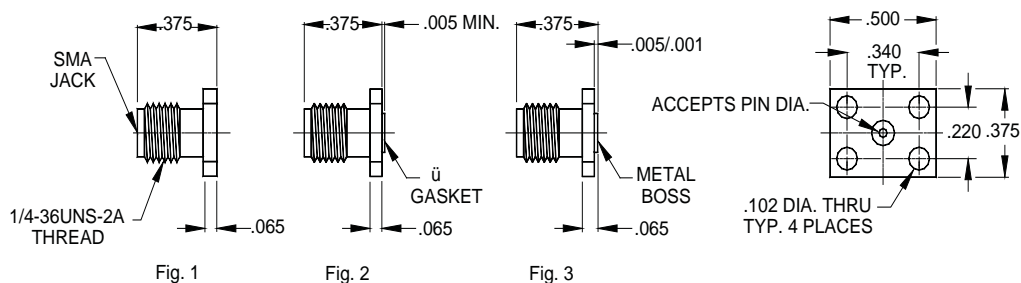

PART NUMBER	Fig.	ACCEPTS PIN DIA	MATERIAL TYPE	FREQUENCY RANGE
9954-0081-6219	1	.016/.011	STAINLESS STEEL	DC - 26.5 GHz.
9954-0781-6219	2	.016/.011	STAINLESS STEEL	DC - 26.5 GHz.
9954-0881-6219	3	.016/.011	STAINLESS STEEL	DC - 26.5 GHz.
9954-0081-6229	1	.021/.017	STAINLESS STEEL	DC - 26.5 GHz.
9954-0781-6229	2	.021/.017	STAINLESS STEEL	DC - 26.5 GHz.
9954-0881-6229	3	.021/.017	STAINLESS STEEL	DC - 26.5 GHz.
9954-0081-6279	1	.037/.035	STAINLESS STEEL	DC - 26.5 GHz.
9954-0781-6279	2	.037/.035	STAINLESS STEEL	DC - 26.5 GHz.
9954-0881-6279	3	.037/.035	STAINLESS STEEL	DC - 26.5 GHz.

Specifications are subject to change without notice

sma • field replaceable connectors

male, plug, 2 hole flange mount

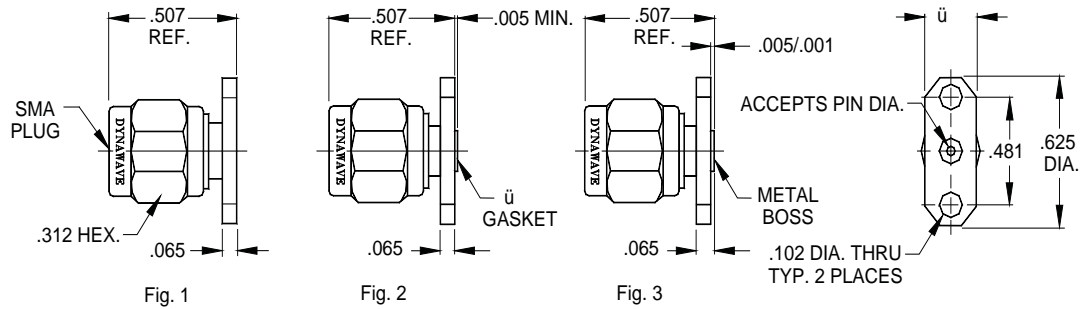

Fig. 1

Fig. 2

Fig. 3

PART NUMBER	Fig.	ACCEPTS PIN DIA.	"A" DIM.	MATERIAL TYPE	FREQUENCY RANGE
9852-0081-6215	1	.016/.011	.222	STAINLESS STEEL	DC - 26.5 GHz.
9852-0781-6215	2	.016/.011	.222	STAINLESS STEEL	DC - 26.5 GHz.
9852-0881-6215	3	.016/.011	.222	STAINLESS STEEL	DC - 26.5 GHz.
9852-0081-6220	1	.021/.017	.222	STAINLESS STEEL	DC - 26.5 GHz.
9852-0781-6220	2	.021/.017	.222	STAINLESS STEEL	DC - 26.5 GHz.
9852-0881-6220	3	.021/.017	.222	STAINLESS STEEL	DC - 26.5 GHz.
9852-0081-6236	1	.037/.035	.222	STAINLESS STEEL	DC - 26.5 GHz.
9852-0781-6236	2	.037/.035	.300	STAINLESS STEEL	DC - 26.5 GHz.
9852-0881-6236	3	.037/.035	.260	STAINLESS STEEL	DC - 26.5 GHz.

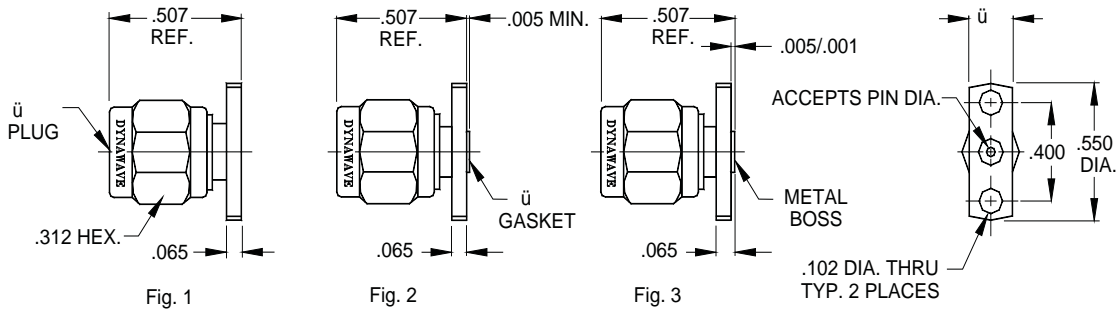

Fig. 1

Fig. 2

Fig. 3

PART NUMBER	Fig.	ACCEPTS PIN DIA.	"A" DIM.	MATERIAL TYPE	FREQUENCY RANGE
9852-0081-6214	1	.016/.011	.190	STAINLESS STEEL	DC - 26.5 GHz.
9852-0781-6214	2	.016/.011	.190	STAINLESS STEEL	DC - 26.5 GHz.
9852-0881-6214	3	.016/.011	.190	STAINLESS STEEL	DC - 26.5 GHz.
9852-0081-6224	1	.021/.017	.190	STAINLESS STEEL	DC - 26.5 GHz.
9852-0781-6224	2	.021/.017	.190	STAINLESS STEEL	DC - 26.5 GHz.
9852-0881-6224	3	.021/.017	.190	STAINLESS STEEL	DC - 26.5 GHz.
9852-0081-6246	1	.037/.035	.190	STAINLESS STEEL	DC - 26.5 GHz.
9852-0781-6246	2	.037/.035	.300	STAINLESS STEEL	DC - 26.5 GHz.
9852-0881-6246	3	.037/.035	.260	STAINLESS STEEL	DC - 26.5 GHz.

sma • field replaceable connectors

male, plug, 4 hole flange mount

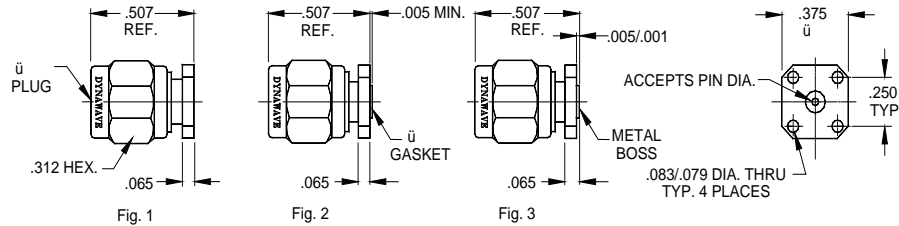

PART NUMBER	Fig.	ACCEPTS PIN DIA	MATERIAL TYPE	FREQUENCY RANGE
9854-0081-6217	1	.016/.011	STAINLESS STEEL	DC - 26.5 GHz.
9854-0781-6217	2	.016/.011	STAINLESS STEEL	DC - 26.5 GHz.
9854-0881-6217	3	.016/.011	STAINLESS STEEL	DC - 26.5 GHz.
9854-0081-6227	1	.021/.017	STAINLESS STEEL	DC - 26.5 GHz.
9854-0781-6227	2	.021/.017	STAINLESS STEEL	DC - 26.5 GHz.
9854-0881-6227	3	.021/.017	STAINLESS STEEL	DC - 26.5 GHz.
9854-0081-6237	1	.037/.035	STAINLESS STEEL	DC - 26.5 GHz.
9854-0781-6237	2	.037/.035	STAINLESS STEEL	DC - 26.5 GHz.
9854-0881-6237	3	.037/.035	STAINLESS STEEL	DC - 26.5 GHz.

male, plug, 4 hole flange mount

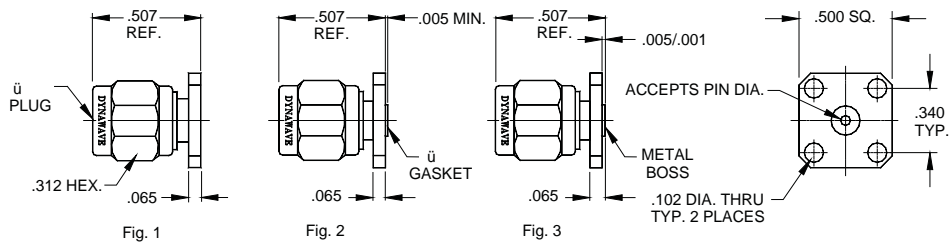

PART NUMBER	Fig.	ACCEPTS PIN DIA	MATERIAL TYPE	FREQUENCY RANGE
9854-0081-6215	1	.016/.011	STAINLESS STEEL	DC - 26.5 GHz.
9854-0781-6215	2	.016/.011	STAINLESS STEEL	DC - 26.5 GHz.
9854-0881-6215	3	.016/.011	STAINLESS STEEL	DC - 26.5 GHz.
9854-0081-6220	1	.021/.017	STAINLESS STEEL	DC - 26.5 GHz.
9854-0781-6220	2	.021/.017	STAINLESS STEEL	DC - 26.5 GHz.
9854-0881-6220	3	.021/.017	STAINLESS STEEL	DC - 26.5 GHz.
9854-0081-6236	1	.037/.035	STAINLESS STEEL	DC - 26.5 GHz.
9854-0781-6236	2	.037/.035	STAINLESS STEEL	DC - 26.5 GHz.
9854-0881-6236	3	.037/.035	STAINLESS STEEL	DC - 26.5 GHz.

Specifications are subject to change without notice

sma • field replaceable connectors

female, jack, 2 hole, right angle, flange mount

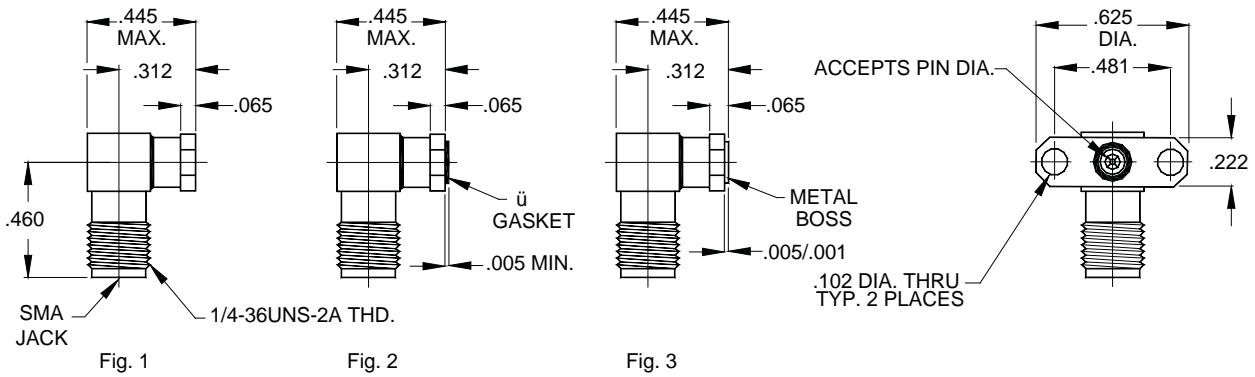

PART NUMBER	Fig.	ACCEPTS PIN DIA	MATERIAL TYPE	FREQUENCY RANGE
9956-0081-6215	1	.016/.011	STAINLESS STEEL	DC - 22.0 GHz.
9956-0781-6215	2	.016/.011	STAINLESS STEEL	DC - 22.0 GHz.
9956-0881-6215	3	.016/.011	STAINLESS STEEL	DC - 22.0 GHz.
9956-0081-6220	1	.021/.017	STAINLESS STEEL	DC - 22.0 GHz.
9956-0781-6220	2	.021/.017	STAINLESS STEEL	DC - 22.0 GHz.
9956-0881-6220	3	.021/.017	STAINLESS STEEL	DC - 22.0 GHz.

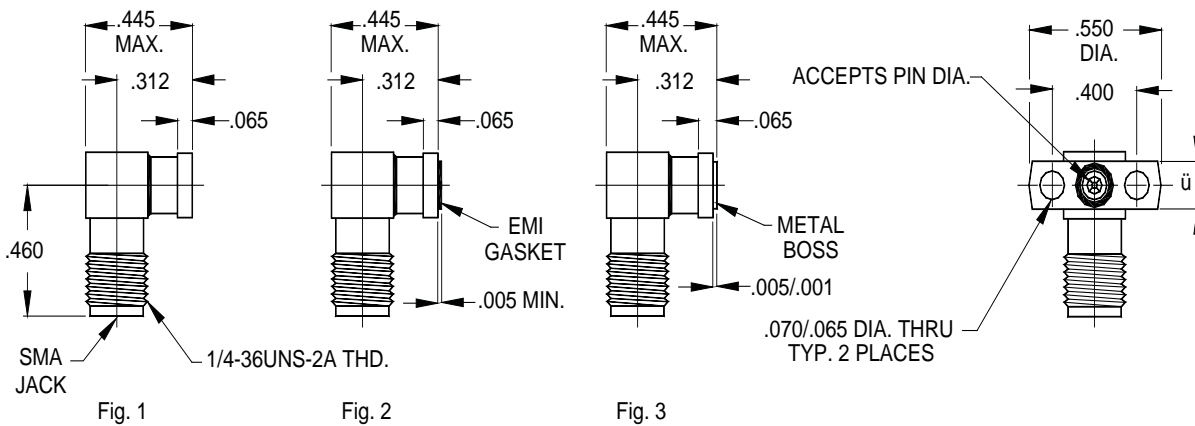

PART NUMBER	Fig.	ACCEPTS PIN DIA	MATERIAL TYPE	FREQUENCY RANGE
9956-0081-6214	1	.016/.011	STAINLESS STEEL	DC - 22.0 GHz.
9956-0781-6214	2	.016/.011	STAINLESS STEEL	DC - 22.0 GHz.
9956-0881-6214	3	.016/.011	STAINLESS STEEL	DC - 22.0 GHz.
9956-0081-6224	1	.021/.017	STAINLESS STEEL	DC - 22.0 GHz.
9956-0781-6224	2	.021/.017	STAINLESS STEEL	DC - 22.0 GHz.
9956-0881-6224	3	.021/.017	STAINLESS STEEL	DC - 22.0 GHz.

sma • field replaceable connectors

female, jack, 2 hole, right angle, flange mount

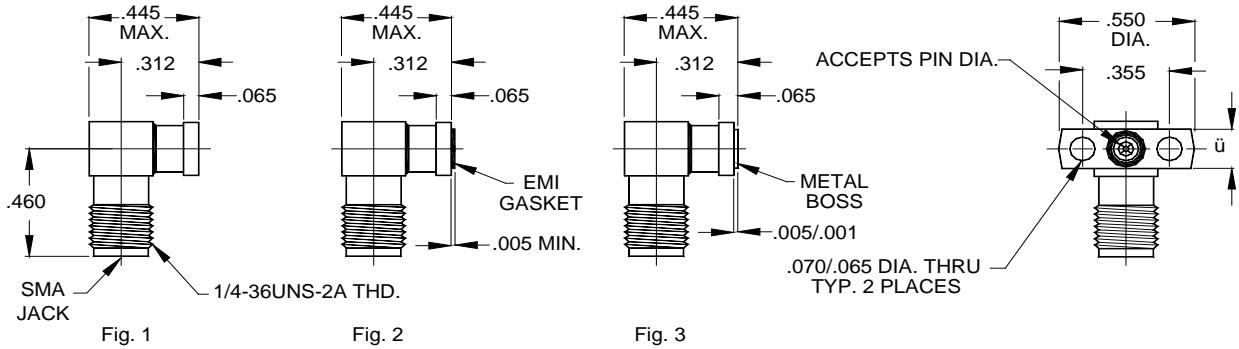

PART NUMBER	Fig.	ACCEPTS PIN DIA	MATERIAL TYPE	FREQUENCY RANGE
9956-0081-6213	1	.016/.011	STAINLESS STEEL	DC - 22.0 GHz.
9956-0781-6213	2	.016/.011	STAINLESS STEEL	DC - 22.0 GHz.
9956-0881-6213	3	.016/.011	STAINLESS STEEL	DC - 22.0 GHz.
9956-0081-6223	1	.021/.017	STAINLESS STEEL	DC - 22.0 GHz.
9956-0781-6223	2	.021/.017	STAINLESS STEEL	DC - 22.0 GHz.
9956-0881-6223	3	.021/.017	STAINLESS STEEL	DC - 22.0 GHz.

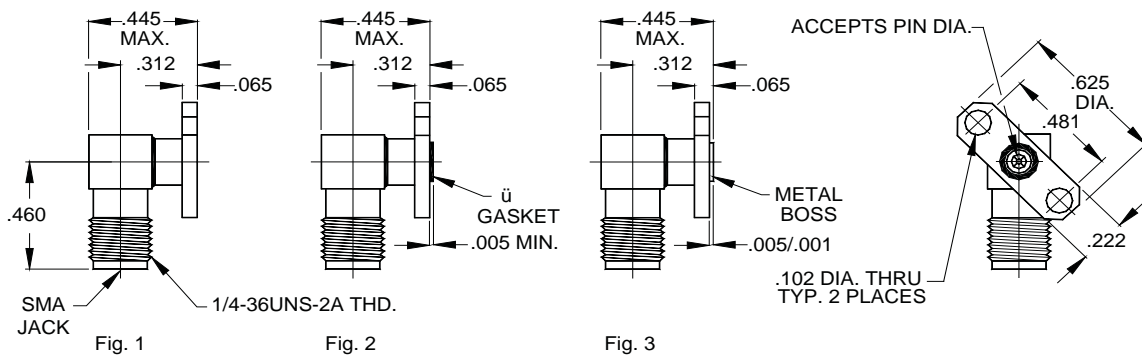

PART NUMBER	Fig.	ACCEPTS PIN DIA	MATERIAL TYPE	FREQUENCY RANGE
9956-1081-6215	1	.016/.011	STAINLESS STEEL	DC - 22.0 GHz.
9956-1781-6215	2	.016/.011	STAINLESS STEEL	DC - 22.0 GHz.
9956-1881-6215	3	.016/.011	STAINLESS STEEL	DC - 22.0 GHz.
9956-1081-6220	1	.021/.017	STAINLESS STEEL	DC - 22.0 GHz.
9956-1781-6220	2	.021/.017	STAINLESS STEEL	DC - 22.0 GHz.
9956-1881-6220	3	.021/.017	STAINLESS STEEL	DC - 22.0 GHz.

Specifications are subject to change without notice

sma • field replaceable connectors

female, jack, 2 hole, right angle, flange mount

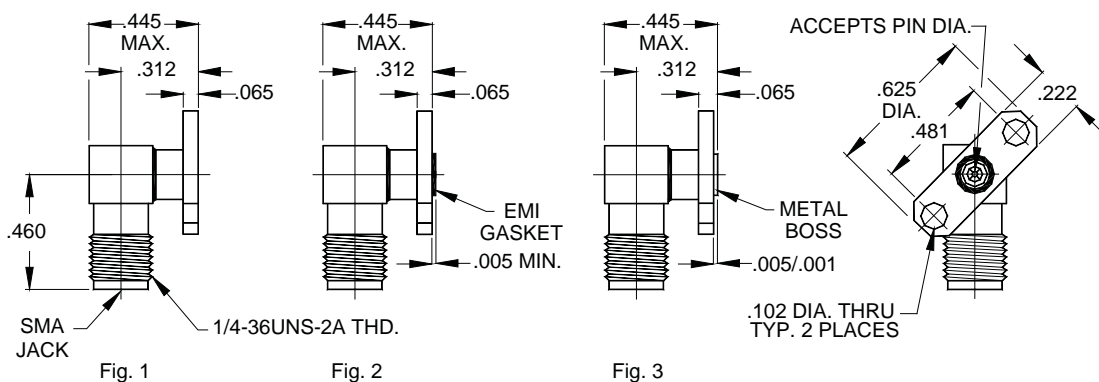

PART NUMBER	Fig.	ACCEPTS PIN DIA	MATERIAL TYPE	FREQUENCY RANGE
9956-2081-6215	1	.016/.011	STAINLESS STEEL	DC - 22.0 GHz.
9956-2781-6215	2	.016/.011	STAINLESS STEEL	DC - 22.0 GHz.
9956-2881-6215	3	.016/.011	STAINLESS STEEL	DC - 22.0 GHz.
9956-2081-6220	1	.021/.017	STAINLESS STEEL	DC - 22.0 GHz.
9956-2781-6220	2	.021/.017	STAINLESS STEEL	DC - 22.0 GHz.
9956-2881-6220	3	.021/.017	STAINLESS STEEL	DC - 22.0 GHz.

female, jack, 4 hole, right angle, flange mount

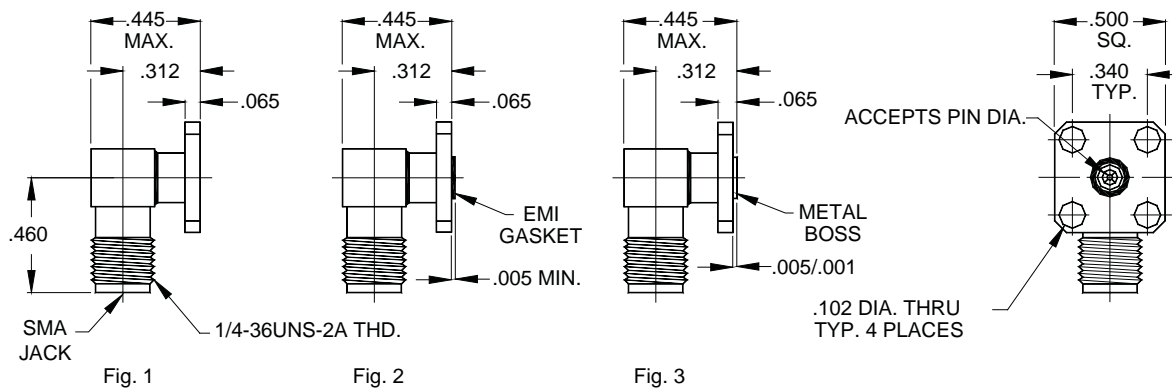

PART NUMBER	Fig.	ACCEPTS PIN DIA	MATERIAL TYPE	FREQUENCY RANGE
9958-0081-6215	1	.016/.011	STAINLESS STEEL	DC - 22.0 GHz.
9958-0781-6215	2	.016/.011	STAINLESS STEEL	DC - 22.0 GHz.
9958-0881-6215	3	.016/.011	STAINLESS STEEL	DC - 22.0 GHz.
9958-0081-6220	1	.021/.017	STAINLESS STEEL	DC - 22.0 GHz.
9958-0781-6220	2	.021/.017	STAINLESS STEEL	DC - 22.0 GHz.
9958-0881-6220	3	.021/.017	STAINLESS STEEL	DC - 22.0 GHz.

sma • straight terminal

female, jack, 2 hole flange mount, with dielectric

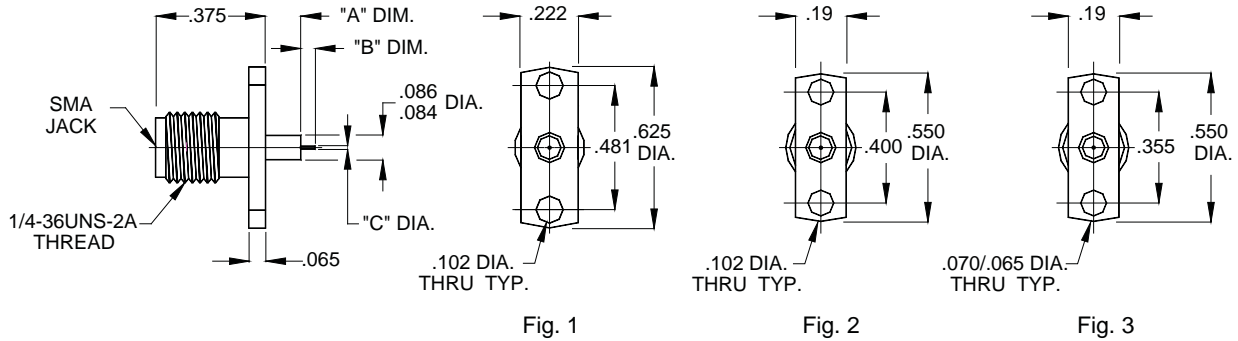

PART NUMBER	Fig.	"A" DIM.	"B" DIM.	"C" DIA.	MATERIAL TYPE	FREQ. RANGE
9952-0032-6201	1	.250	.050	.011/.009	STAINLESS STEEL	DC - 26.5 GHz.
9952-0032-6211	2	.250	.050	.011/.009	STAINLESS STEEL	DC - 26.5 GHz.
9952-0032-6221	3	.250	.050	.011/.009	STAINLESS STEEL	DC - 26.5 GHz.
9952-0032-6204	1	.125	.050	.011/.009	STAINLESS STEEL	DC - 26.5 GHz.
9952-0032-6214	2	.125	.050	.011/.009	STAINLESS STEEL	DC - 26.5 GHz.
9952-0032-6224	3	.125	.050	.011/.009	STAINLESS STEEL	DC - 26.5 GHz.
9952-0032-6207	1	.057	.050	.011/.009	STAINLESS STEEL	DC - 26.5 GHz.
9952-0032-6217	2	.057	.050	.011/.009	STAINLESS STEEL	DC - 26.5 GHz.
9952-0032-6227	3	.057	.050	.011/.009	STAINLESS STEEL	DC - 26.5 GHz.

female, jack, 2 hole flange mount, without dielectric

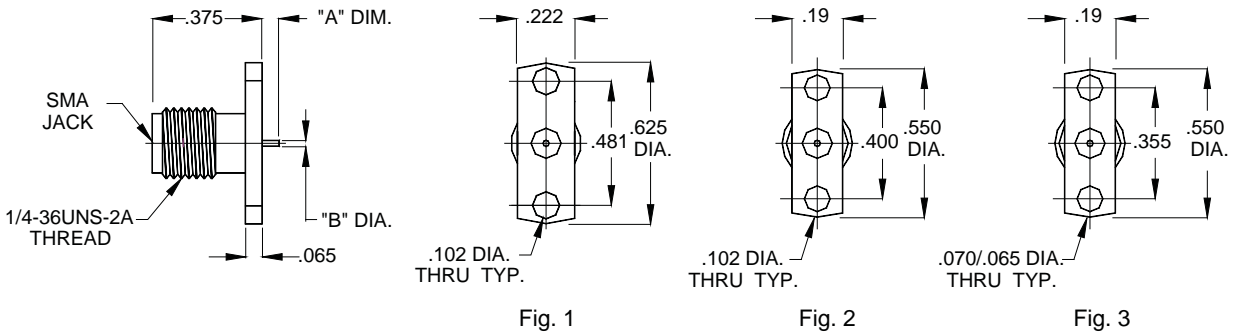

PART NUMBER	Fig.	"A" DIM.	"B" DIM.	MATERIAL TYPE	FREQUENCY RANGE
9952-0032-6222	1	.250	.021/.019	STAINLESS STEEL	DC - 26.5 GHz.
9952-0032-6223	2	.250	.021/.019	STAINLESS STEEL	DC - 26.5 GHz.
9952-0032-6228	3	.250	.021/.019	STAINLESS STEEL	DC - 26.5 GHz.
9952-0032-6235	1	.125	.016/.014	STAINLESS STEEL	DC - 26.5 GHz.
9952-0032-6236	2	.125	.016/.014	STAINLESS STEEL	DC - 26.5 GHz.
9952-0032-6237	3	.125	.016/.014	STAINLESS STEEL	DC - 26.5 GHz.
9952-0032-6245	1	.057	.011/.009	STAINLESS STEEL	DC - 26.5 GHz.
9952-0032-6246	2	.057	.011/.009	STAINLESS STEEL	DC - 26.5 GHz.
9952-0032-6247	3	.057	.011/.009	STAINLESS STEEL	DC - 26.5 GHz.

Specifications are subject to change without notice

sma • straight terminal

female, jack, 4 hole flange mount, with dielectric

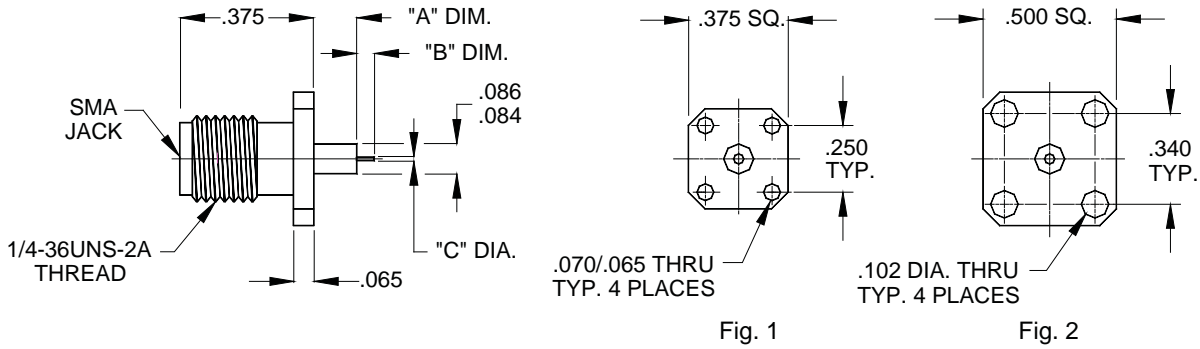

PART NUMBER	Fig.	"A" DIM.	"B" DIM.	"C" DIA.	MATERIAL TYPE	FREQ. RANGE
9954-0032-6207	1	.125	.050	.011/.009	STAINLESS STEEL	DC - 26.5 GHz.
9954-0032-6210	2	.125	.050	.011/.009	STAINLESS STEEL	DC - 26.5 GHz.
9954-0032-6245	1	.057	.050	.011/.009	STAINLESS STEEL	DC - 26.5 GHz.
9954-0032-6211	2	.057	.050	.011/.009	STAINLESS STEEL	DC - 26.5 GHz.

female, jack, 4 hole flange mount, without dielectric

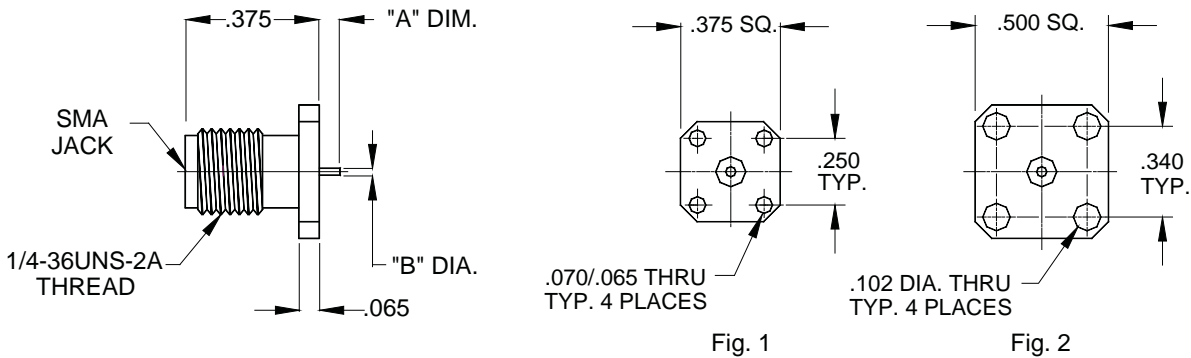

PART NUMBER	Fig.	"A" DIM.	"B" DIM.	MATERIAL TYPE	FREQUENCY RANGE
9954-0032-6225	1	.250	.021/.019	STAINLESS STEEL	DC - 26.5 GHz.
9954-0032-6226	2	.250	.021/.019	STAINLESS STEEL	DC - 26.5 GHz.
9954-0032-6235	1	.125	.016/.014	STAINLESS STEEL	DC - 26.5 GHz.
9954-0032-6236	2	.125	.021/.014	STAINLESS STEEL	DC - 26.5 GHz.
9954-0032-6247	1	.057	.011/.009	STAINLESS STEEL	DC - 26.5 GHz.
9954-0032-6246	2	.057	.011/.009	STAINLESS STEEL	DC - 26.5 GHz.

sma • straight terminal

female, jack, 2 hole flange mount, with dielectric

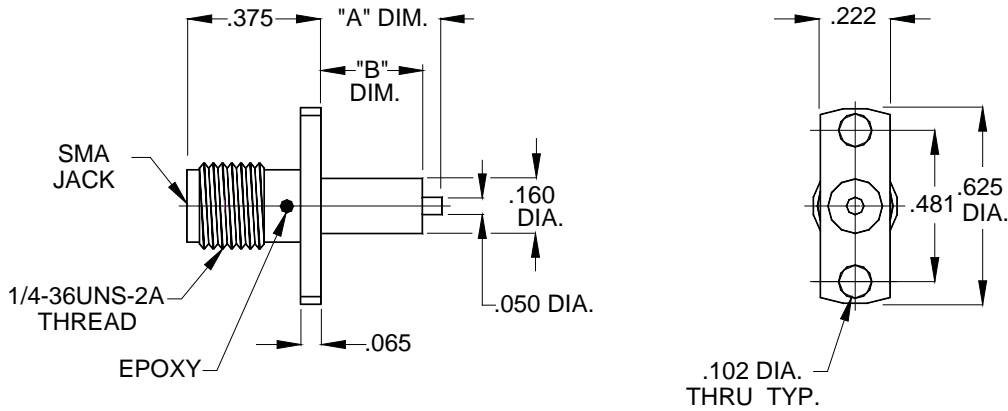

PART NUMBER	"A" DIM.	"B" DIM.	MATERIAL TYPE	FREQUENCY RANGE
9952-0032-2400	.705	.59	BRASS	DC - 18.0 GHz.
9952-0032-6250	.705	.59	STAINLESS STEEL	DC - 18.0 GHz.
9952-0032-6255	.255	.24	STAINLESS STEEL	DC - 18.0 GHz.

female, jack, 4 hole flange mount, with dielectric

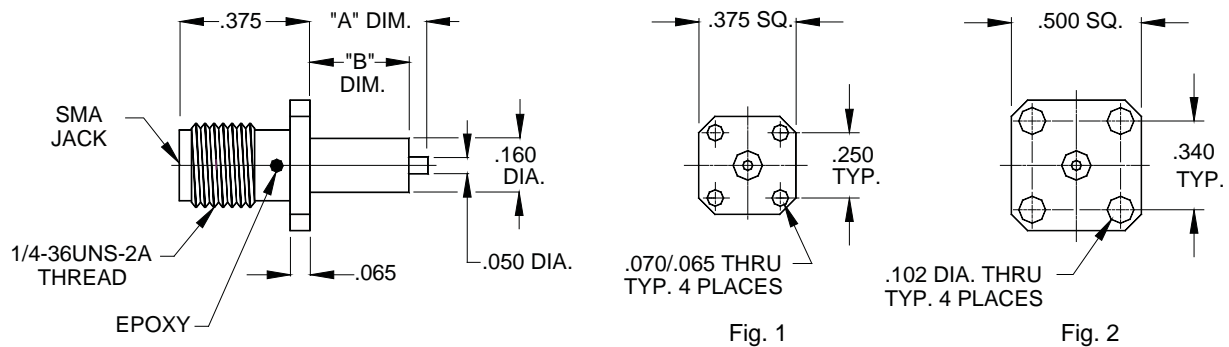

PART NUMBER	Fig .	"A" DIM.	"B" DIM.	MATERIAL TYPE	FREQUENCY RANGE
9954-0032-2410	1	.705	.59	BRASS	DC - 18.0 GHz.
9954-0032-2400	2	.705	.59	BRASS	DC - 18.0 GHz.
9954-0032-6204	1	.705	.59	STAINLESS STEEL	DC - 18.0 GHz.
9954-0032-6250	2	.705	.59	STAINLESS STEEL	DC - 18.0 GHz.
9954-0032-2349	2	.470	.40	BRASS	DC - 18.0 GHz.
9954-0032-6251	2	.175	.12	STAINLESS STEEL	DC - 18.0 GHz.

Specifications are subject to change without notice

sma • straight terminal

male, plug, 2 hole flange mount, with dielectric

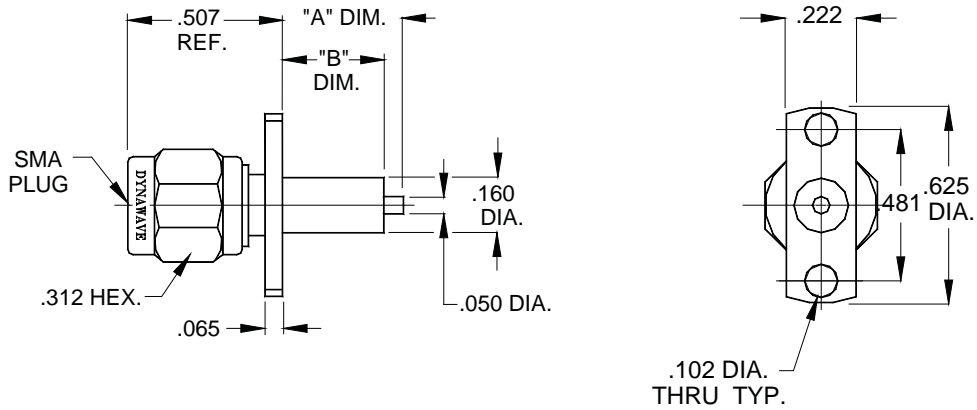

PART NUMBER	"A" DIM.	"B" DIM.	MATERIAL TYPE	FREQUENCY RANGE
9852-0032-2400	.705	.59	BRASS	DC - 18.0 GHz.
9852-0032-6250	.705	.59	STAINLESS STEEL	DC - 18.0 GHz.
9852-0032-6255	.255	.24	STAINLESS STEEL	DC - 18.0 GHz.

male, plug, 4 hole flange mount, with dielectric

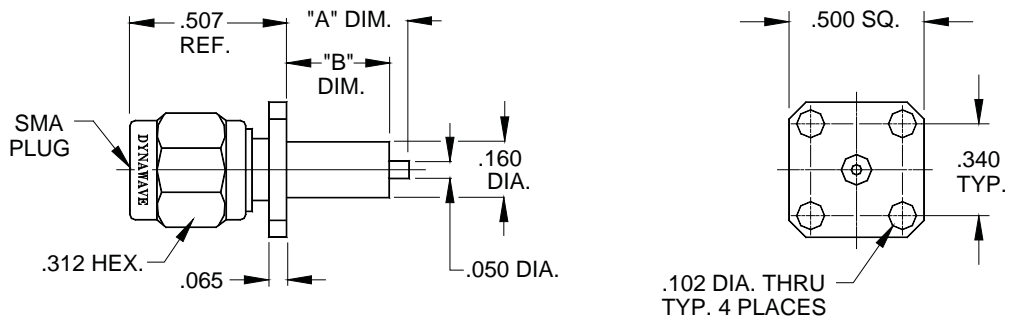

PART NUMBER	"A" DIM.	"B" DIM.	MATERIAL TYPE	FREQUENCY RANGE
9854-0032-2400	.705	.59	BRASS	DC - 18.0 GHz.
9854-0032-6250	.705	.59	STAINLESS STEEL	DC - 18.0 GHz.
9854-0032-6255	.255	.24	STAINLESS STEEL	DC - 18.0 GHz.

sma • slotted terminal

female, jack, 4 hole flange mount

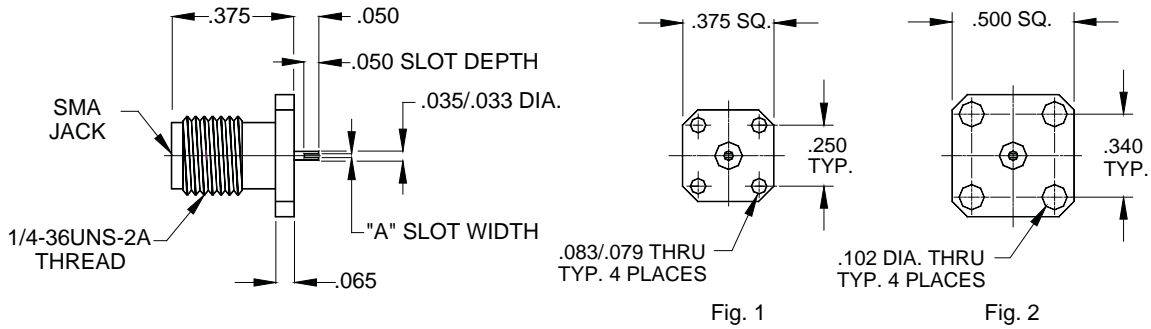

PART NUMBER	Fig.	"A" SLOT WIDTH	MATERIAL TYPE	FREQUENCY RANGE
9954-0012-6217	1	.014/.010	STAINLESS STEEL	DC - 18.0 GHz.
9954-0012-6256	2	.016/.012	STAINLESS STEEL	DC - 18.0 GHz.
9954-0012-6252	2	.021/.017	STAINLESS STEEL	DC - 18.0 GHz.

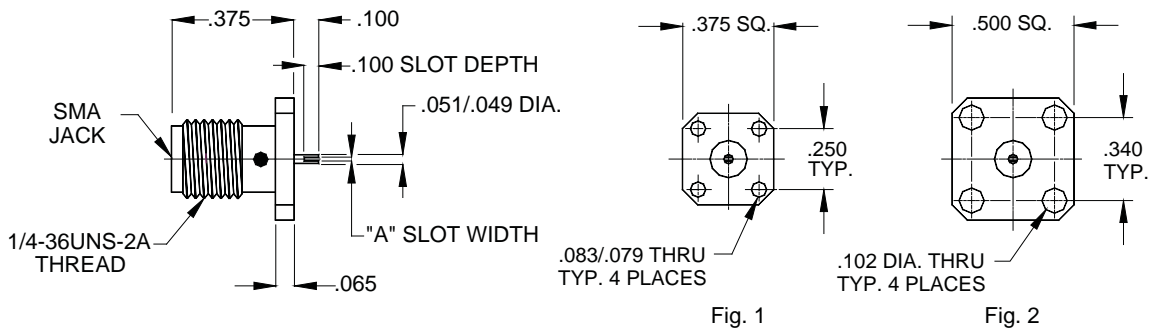

PART NUMBER	Fig.	"A" SLOT WIDTH	MATERIAL TYPE	FREQUENCY RANGE
9954-0012-6249	1	.015/.010	STAINLESS STEEL	DC - 18.0 GHz.
9954-0012-6250	2	.015/.012	STAINLESS STEEL	DC - 18.0 GHz.
9954-0012-6251	2	.021/.017	STAINLESS STEEL	DC - 18.0 GHz.

Specifications are subject to change without notice

sma • tab terminal

female, jack, 2 hole flange mount

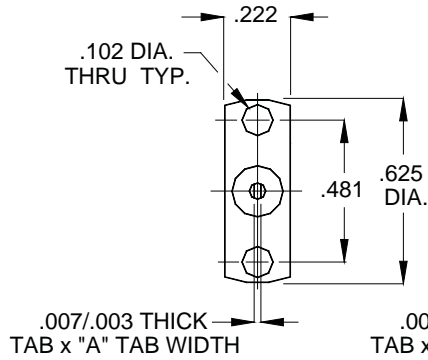
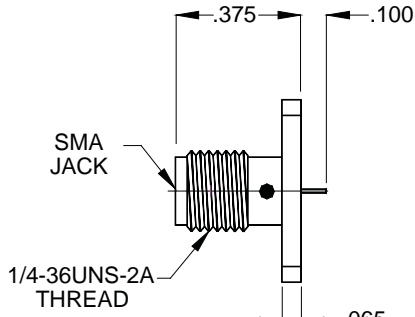

Fig. 1

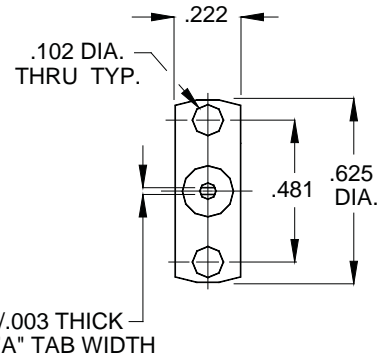

Fig. 2

PART NUMBER	Fig.	"A" TAB WIDTH	MATERIAL TYPE	FREQUENCY RANGE
9952-0052-6227	1	.020	STAINLESS STEEL	DC - 18.0 GHz.
9952-0052-6228	2	.020	STAINLESS STEEL	DC - 18.0 GHz.
9952-0052-6217	1	.050	STAINLESS STEEL	DC - 18.0 GHz.
9952-0052-6218	2	.050	STAINLESS STEEL	DC - 18.0 GHz.

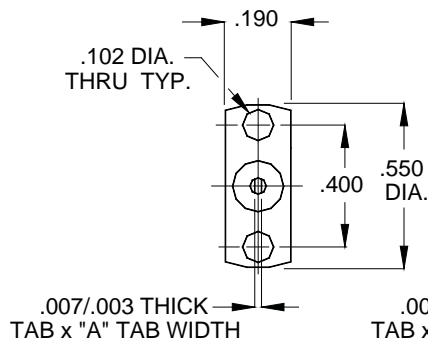
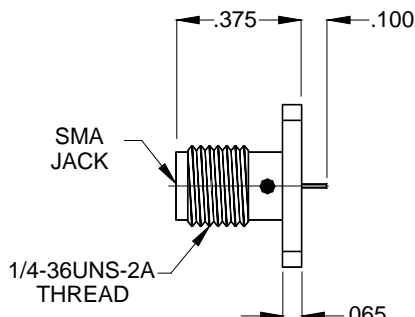

Fig. 1

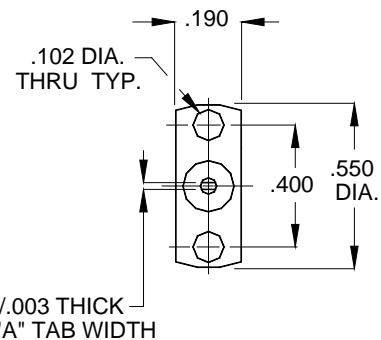

Fig. 2

PART NUMBER	Fig.	"A" TAB WIDTH	MATERIAL TYPE	FREQUENCY RANGE
9952-0052-6214	1	.020	STAINLESS STEEL	DC - 18.0 GHz.
9952-0052-6224	2	.020	STAINLESS STEEL	DC - 18.0 GHz.
9952-0052-6234	1	.050	STAINLESS STEEL	DC - 18.0 GHz.
9952-0052-6244	2	.050	STAINLESS STEEL	DC - 18.0 GHz.

Specifications are subject to change without notice

sma • tab terminal

female, jack, 4 hole flange mount

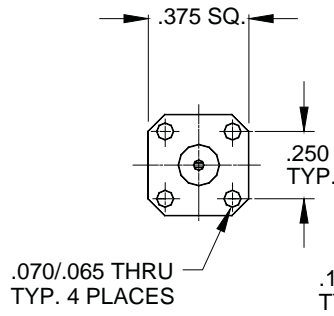
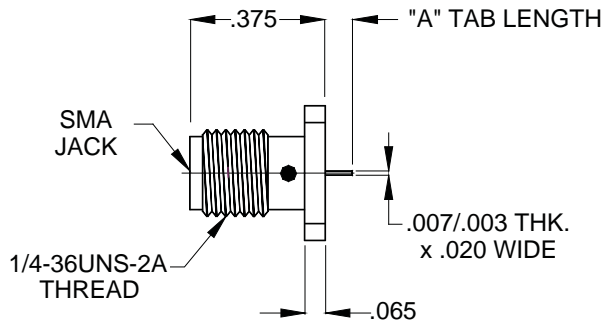

Fig. 1

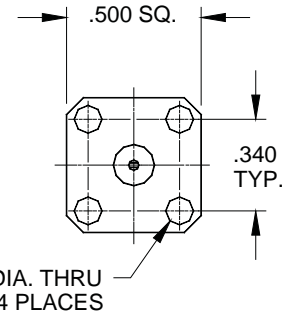

Fig. 2

PART NUMBER	Fig.	"A" TAB LENGTH	MATERIAL TYPE	FREQUENCY RANGE
9954-0052-6287	1	.100	STAINLESS STEEL	DC - 18.0 GHz.
9954-0052-6249	2	.100	STAINLESS STEEL	DC - 18.0 GHz.

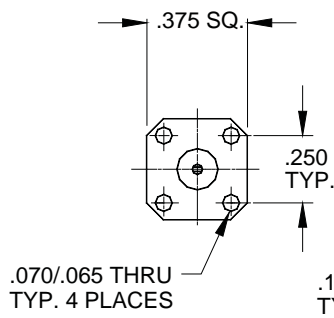
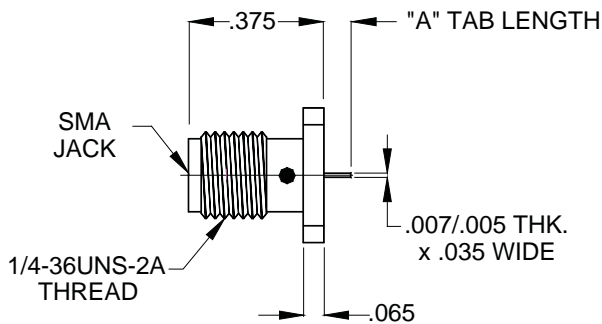

Fig. 1

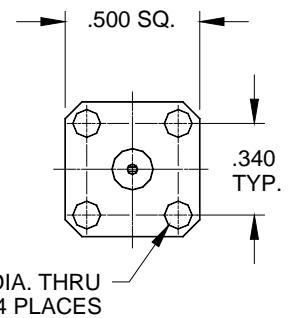

Fig. 2

PART NUMBER	Fig.	"A" TAB LENGTH	MATERIAL TYPE	FREQUENCY RANGE
9954-0052-6207	1	.035	STAINLESS STEEL	DC - 18.0 GHz.
9954-0052-6278	2	.035	STAINLESS STEEL	DC - 18.0 GHz.
9954-0052-6247	1	.050	STAINLESS STEEL	DC - 18.0 GHz.
9954-0052-6248	2	.050	STAINLESS STEEL	DC - 18.0 GHz.

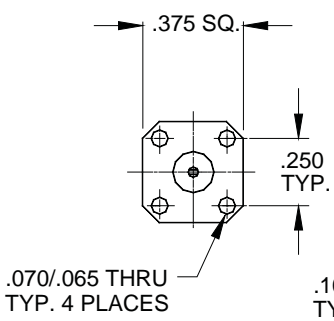
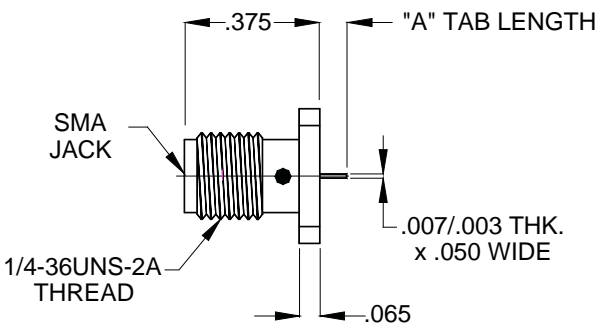

Fig. 1

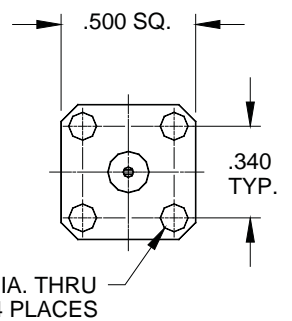

Fig. 2

PART NUMBER	Fig.	"A" TAB LENGTH	MATERIAL TYPE	FREQUENCY RANGE
9954-0052-6238	1	.100	STAINLESS STEEL	DC - 18.0 GHz.
9954-0052-6218	2	.100	STAINLESS STEEL	DC - 18.0 GHz.

Specifications are subject to change without notice

sma • field replaceable connectors

female, jack, thread-in

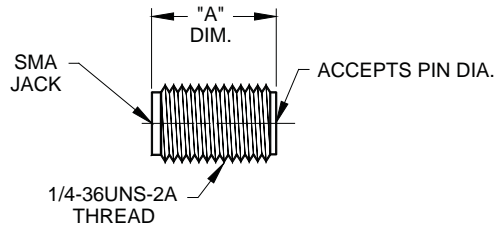

TORQUE TOOL : 99-TORQUE-30

PART NUMBER	ACCEPTS PIN DIA	"A" DIM.	MATERIAL TYPE	FREQUENCY RANGE
9930-0081-6212	.016/.011	.425	STAINLESS STEEL	DC - 26.5 GHz.
9930-0081-6215	.016/.011	.375	STAINLESS STEEL	DC - 26.5 GHz.
9930-0081-6220	.021/.017	.375	STAINLESS STEEL	DC - 26.5 GHz.
9930-0081-6222	.021/.017	.425	STAINLESS STEEL	DC - 26.5 GHz.
9930-0081-6227	.021/.017	.725	STAINLESS STEEL	DC - 26.5 GHz.
9930-0081-6236	.037/.035	.500	STAINLESS STEEL	DC - 26.5 GHz.
9930-0081-6246	.016/.011	.590	STAINLESS STEEL	DC - 26.5 GHz.
9930-0081-6250	.021/.017	.590	STAINLESS STEEL	DC - 26.5 GHz.
9930-0081-6289	.021/.017	.390	STAINLESS STEEL	DC - 26.5 GHz.

male, plug, press-in

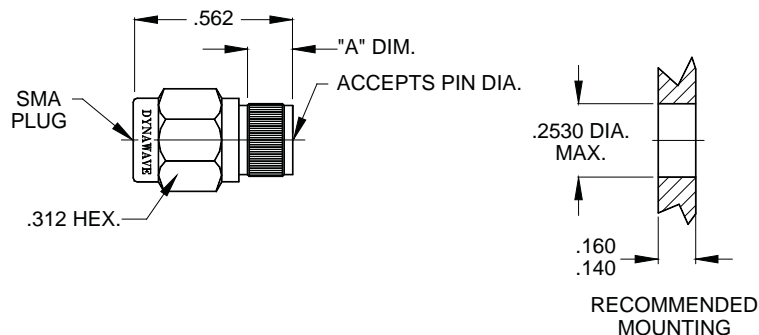

PART NUMBER	ACCEPTS PIN DIA	"A" DIM.	MATERIAL TYPE	FREQUENCY RANGE
9840-0081-6212	.016/.011	.190	STAINLESS STEEL	DC - 26.5 GHz.
9840-0081-6222	.021/.017	.190	STAINLESS STEEL	DC - 26.5 GHz.

sma • hermetic connectors

female, jack, thread-in “sparkplug”

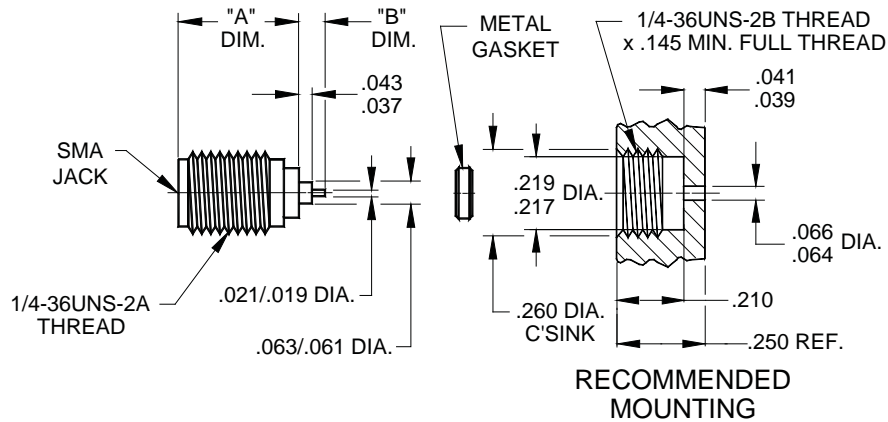

TORQUE TOOL : 99-TORQUE-22

PART NUMBER	“A” DIM.	“B” DIM.	MATERIAL TYPE	FREQUENCY RANGE
9930-0431-6410	1.080	.080	STAINLESS STEEL	DC - 26.5 GHz.
9930-0431-6420	.450	.080	STAINLESS STEEL	DC - 26.5 GHz.
9930-0431-6422	.450	.058	STAINLESS STEEL	DC - 26.5 GHz.
9930-0431-6424	.450	.065	STAINLESS STEEL	DC - 26.5 GHz.
9930-0431-6427	.450	.150	STAINLESS STEEL	DC - 26.5 GHz.
9930-0431-6482	.710	.080	STAINLESS STEEL	DC - 26.5 GHz.

male, plug, thread-in “sparkplug”

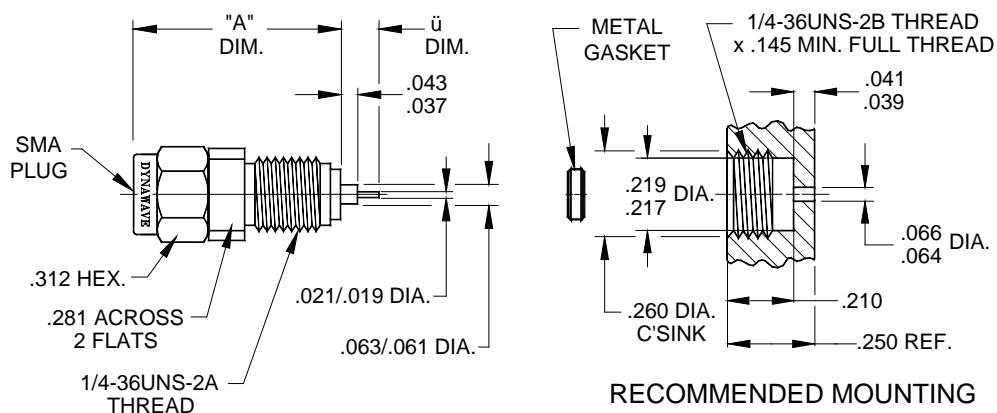

TORQUE TOOL : 9-98019

PART NUMBER	“A” DIM.	“B” DIM.	MATERIAL TYPE	FREQUENCY RANGE
9830-0431-6400	.732/.692	.080	STAINLESS STEEL	DC - 26.5 GHz.
9830-0431-6422	.732/.692	.058	STAINLESS STEEL	DC - 26.5 GHz.
9830-0431-6444	.732/.692	.065	STAINLESS STEEL	DC - 26.5 GHz.

Specifications are subject to change without notice

sma • hermetic connectors

female, jack, thread-in, knife edge “sparkplug”, sliding contact

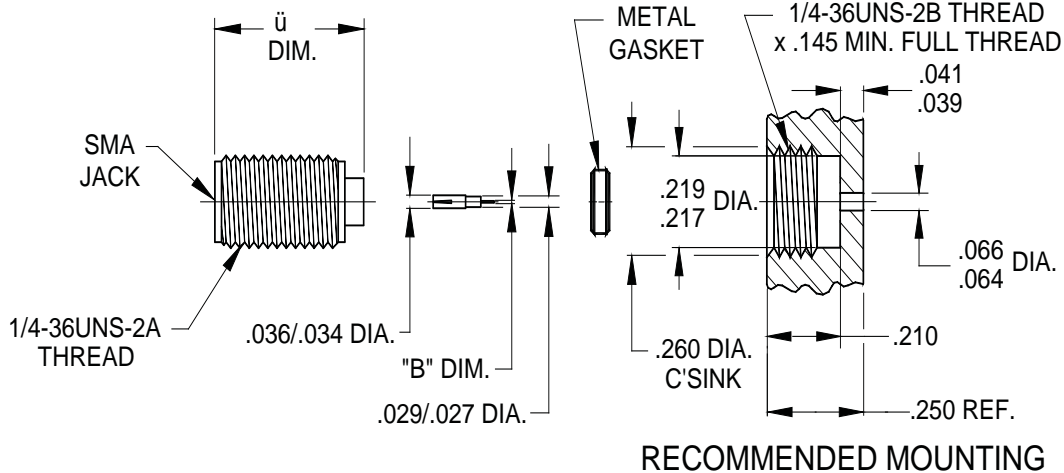

TORQUE TOOL : 99-TORQUE-22

PART NUMBER	"A" DIM.	"B" DIM.	MATERIAL TYPE	FREQUENCY RANGE
9930-0441-6440	.455	.020 DIA.	STAINLESS STEEL	DC - 26.5 GHz.
9930-0441-6441	.455	.006 x .020	STAINLESS STEEL	DC - 26.5 GHz.
9930-0441-6442	.455	.007 DIA.	STAINLESS STEEL	DC - 26.5 GHz.

female, jack, thread-in, knife edge, field replaceable, “sparkplug”

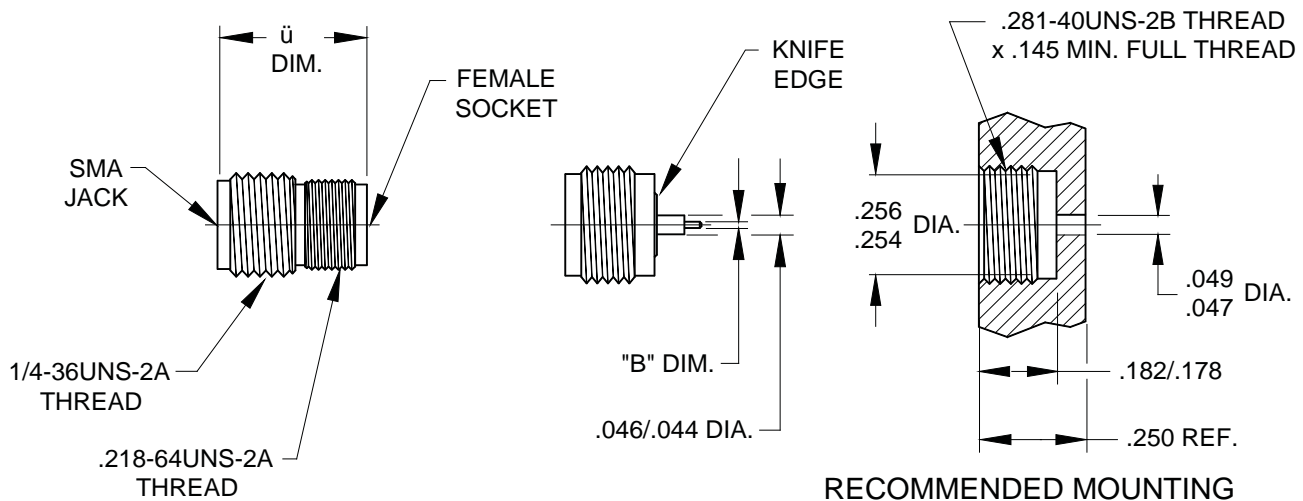

TORQUE TOOL : 99-TORQUE-22

PART NUMBER	"A" DIM.	"B" DIM.	MATERIAL TYPE	FREQUENCY RANGE
9933-0431-6415	.350	.015	STAINLESS STEEL	DC - 26.5 GHz.

sma • printed circuit board mount

female, jack, straight, 4 post, thru hole

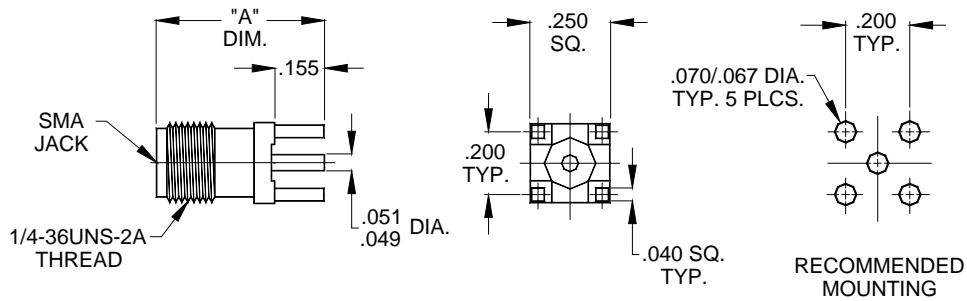

PART NUMBER	"A" DIM.	"B" DIM.	MATERIAL TYPE	FREQUENCY RANGE
9920-0031-2150	.411	.155	BRASS	DC - 18.0 GHz.
9920-0031-2725	.530	.155	BRASS	DC - 18.0 GHz.
9920-0031-6425	.530	.155	STAINLESS STEEL	DC - 18.0 GHz.

female, jack, right angle, 4 post, thru hole

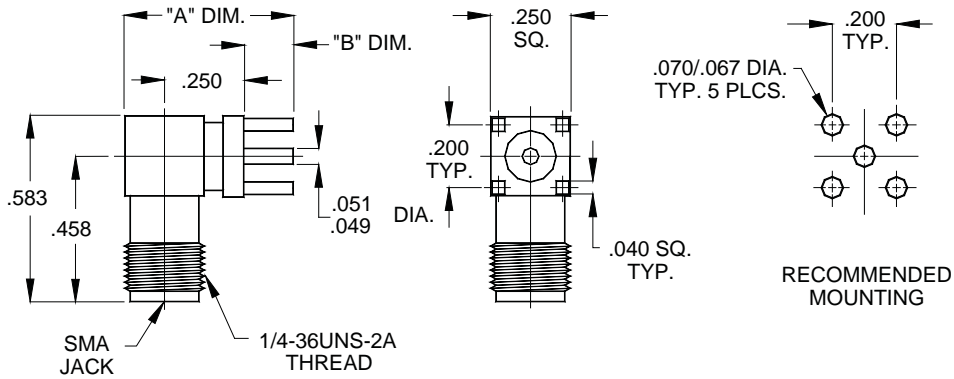

PART NUMBER	"A" DIM.	"B" DIM.	MATERIAL TYPE	FREQUENCY RANGE
9921-0031-2100	.530	.155	BRASS	DC - 18.0 GHz.
9921-0031-2725	.530	.155	BRASS	DC - 18.0 GHz.
9921-0031-6425	.530	.155	STAINLESS STEEL	DC - 18.0 GHz.

Specifications are subject to change without notice

sma • printed circuit board mount

female, jack, straight, edge mount

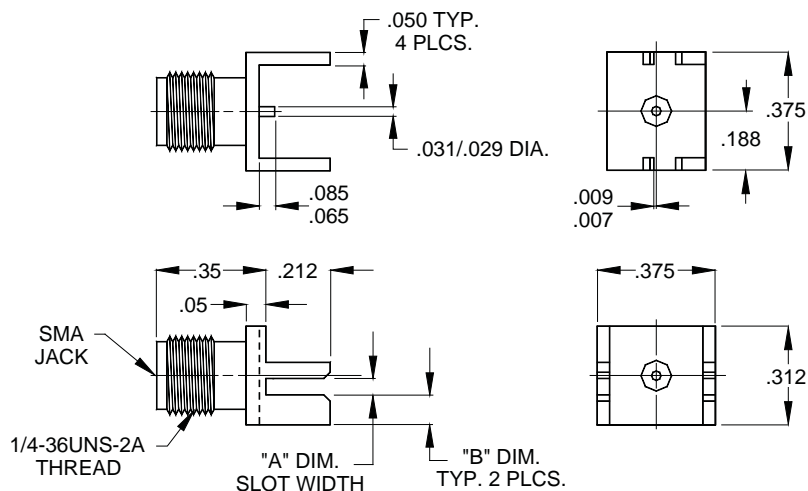

PART NUMBER	"A" DIM.	"B" DIM.	MATERIAL TYPE	FREQUENCY RANGE
9920-0032-2100	.040/.034	.104	BRASS	DC - 18.0 GHz.
9920-0032-2101	.066/.063	.078	BRASS	DC - 18.0 GHz.
9920-0032-2301	.066/.063	.078	BRASS	DC - 18.0 GHz.

female, jack, straight, edge mount

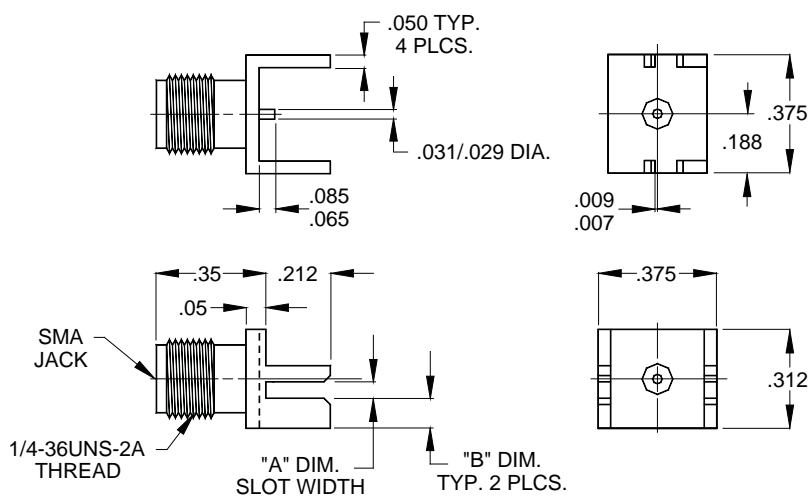

PART NUMBER	"A" DIM.	"B" DIM.	MATERIAL TYPE	FREQUENCY RANGE
9920-0032-2104	.066/.063	.084	BRASS	DC - 20.0 GHz.
9920-0032-2105	.036/.033	.114	BRASS	DC - 20.0 GHz.

sma • printed circuit board mount

female, jack, straight, edge mount

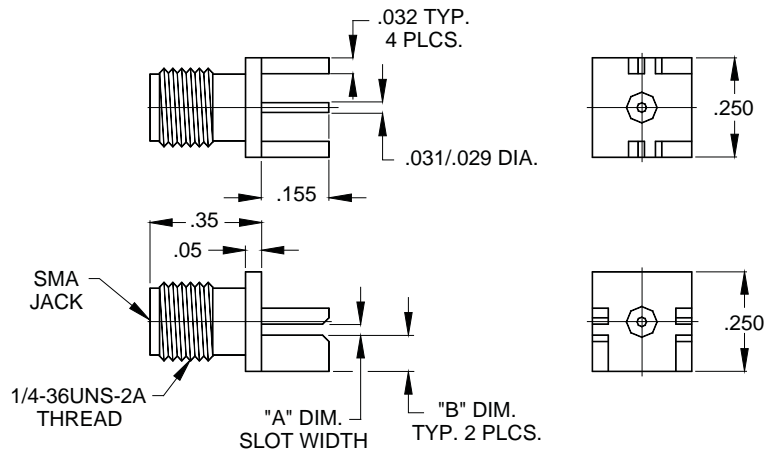

PART NUMBER	"A" DIM.	"B" DIM.	MATERIAL TYPE	FREQUENCY RANGE
9920-0531-2701	.032/.028	.080	BRASS	DC - 18.0 GHz.
9920-0531-2702	.050/.046	.062	BRASS	DC - 18.0 GHz.
9920-0531-2704	.070/.066	.042	BRASS	DC - 18.0 GHz.

female, jack, straight, edge mount

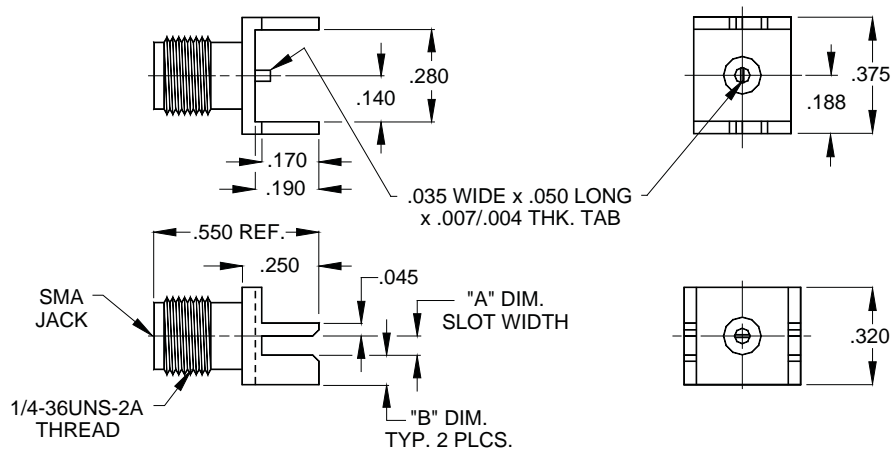

PART NUMBER	"A" DIM.	"B" DIM.	MATERIAL TYPE	FREQUENCY RANGE
9920-0051-6436	.074/.070	.088	BRASS	DC - 20.0 GHz.

Specifications are subject to change without notice

sma • printed circuit board mount

female, jack, straight, surface mount, non-captured contact

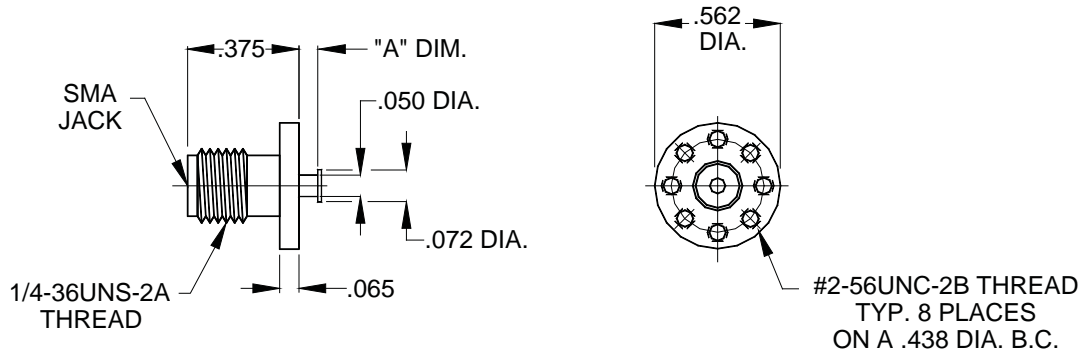

PART NUMBER	"A" DIM	MATERIAL TYPE	FREQUENCY RANGE
9980-0030-6202	.031	STAINLESS STEEL	DC - 25.0 GHz.
9980-0030-6201	.062	STAINLESS STEEL	DC - 25.0 GHz.
9980-0030-6200	.125	STAINLESS STEEL	DC - 25.0 GHz.

female, jack, right angle, surface mount, non-captured contact

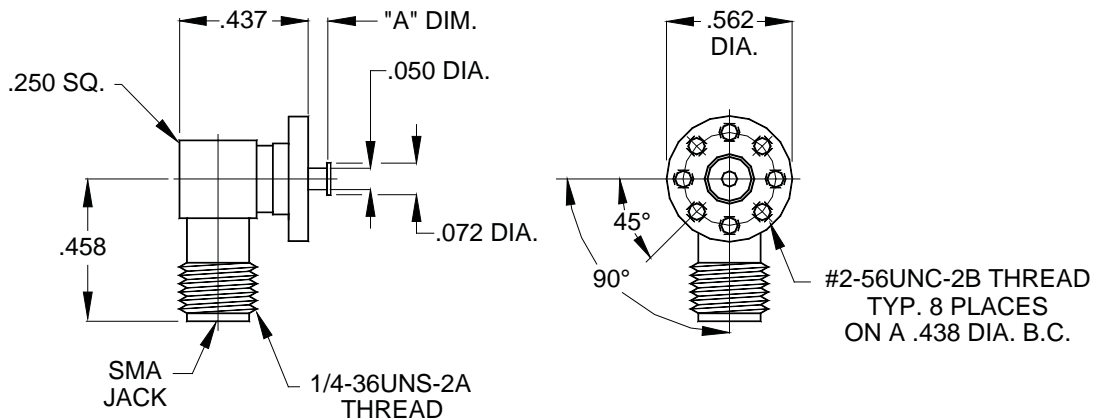

PART NUMBER	"A" DIM	MATERIAL TYPE	FREQUENCY RANGE
9981-0361-6201	.031	STAINLESS STEEL	DC - 18.0 GHz.
9981-0361-6202	.062	STAINLESS STEEL	DC - 18.0 GHz.
9981-0361-6203	.125	STAINLESS STEEL	DC - 18.0 GHz.

sma • printed circuit board mount

female, jack, straight, surface mount, non-captured contact

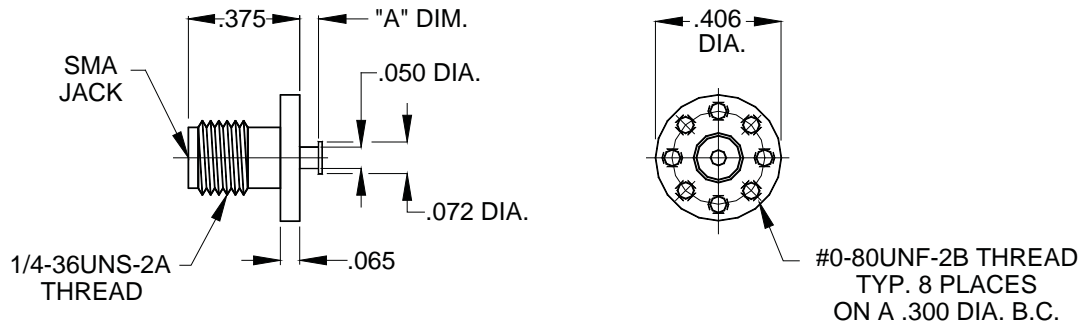

PART NUMBER	"A" DIM	MATERIAL TYPE	FREQUENCY RANGE
9980-0030-6230	.031	STAINLESS STEEL	DC - 25.0 GHz.
9980-0030-6240	.062	STAINLESS STEEL	DC - 25.0 GHz.
9980-0030-6250	.125	STAINLESS STEEL	DC - 25.0 GHz.

female, jack, right angle, surface mount, non-captured contact

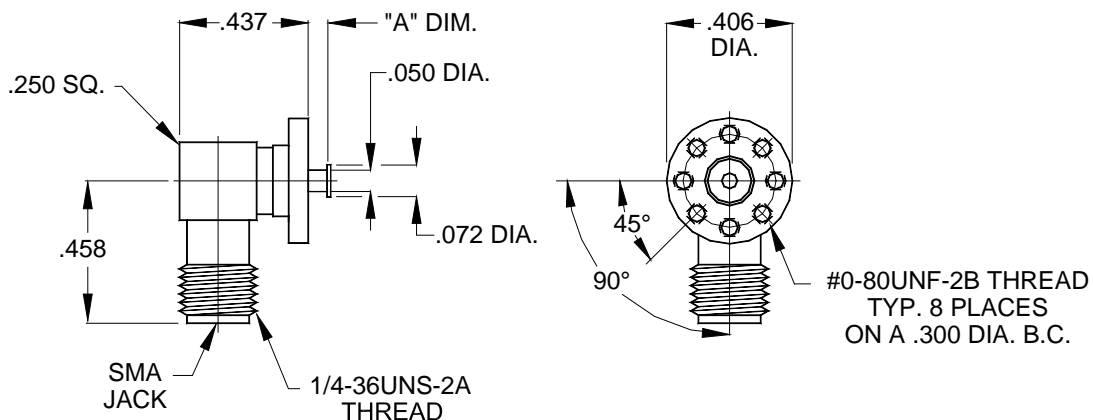

PART NUMBER	"A" DIM	MATERIAL TYPE	FREQUENCY RANGE
9981-0361-6204	.031	STAINLESS STEEL	DC - 18.0 GHz.
9981-0361-6205	.062	STAINLESS STEEL	DC - 18.0 GHz.
9981-0361-6206	.125	STAINLESS STEEL	DC - 18.0 GHz.

Specifications are subject to change without notice

sma • in-series adapters

female, jack to female, jack, straight

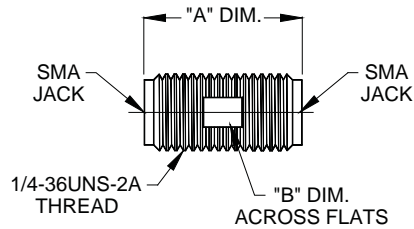

PART NUMBER	"A" DIM	"B" DIM.	MATERIAL TYPE	FREQUENCY RANGE
1100-9999-6250	.500	.219	STAINLESS STEEL	DC - 26.5 GHz.

male, plug to female, jack, straight

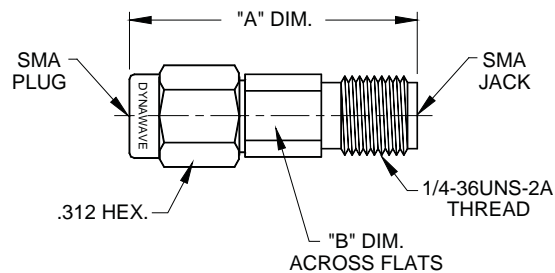

PART NUMBER	"A" DIM	"B" DIM.	MATERIAL TYPE	FREQUENCY RANGE
1100-9899-6200	.720	.219	STAINLESS STEEL	DC - 6.0 GHz.
1100-9899-6272	.720	.219	STAINLESS STEEL	DC - 27.0 GHz.
1100-9899-6220	.766	.280	STAINLESS STEEL	DC - 26.5 GHz.
1100-9899-6221	1.50	.280	STAINLESS STEEL	DC - 26.5 GHz.

male, plug to male, plug, straight

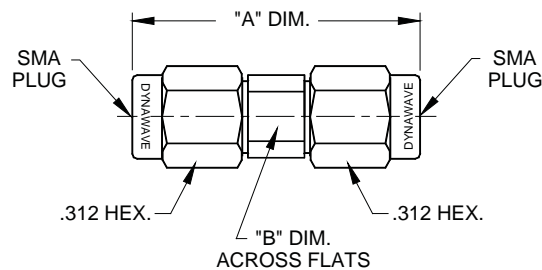

PART NUMBER	"A" DIM	"B" DIM.	MATERIAL TYPE	FREQUENCY RANGE
1100-9898-6220	.800	.312 DIA.	STAINLESS STEEL	DC - 26.5 GHz.
1100-9898-6287	.875	.219	STAINLESS STEEL	DC - 18.0 GHz.

sma • in-series right angle adapters

female, jack to female, jack, right angle

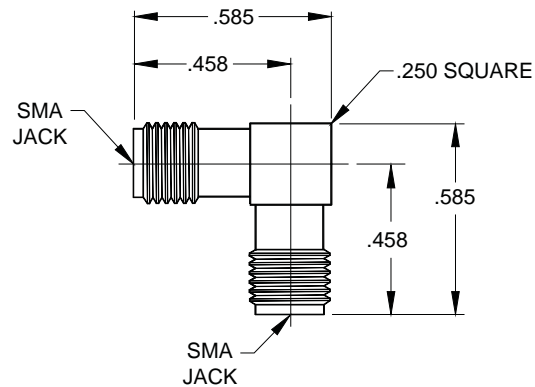

PART NUMBER	MATERIAL TYPE	FREQUENCY RANGE
1101-9999-6250	STAINLESS STEEL	DC - 18.0 GHz.

female, jack to male, plug, right angle

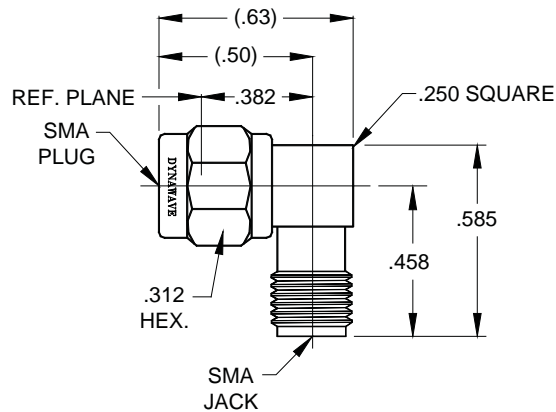

PART NUMBER	MATERIAL TYPE	FREQUENCY RANGE
1101-9899-6250	STAINLESS STEEL	DC - 18.0 GHz.

male, plug to male, plug, right angle

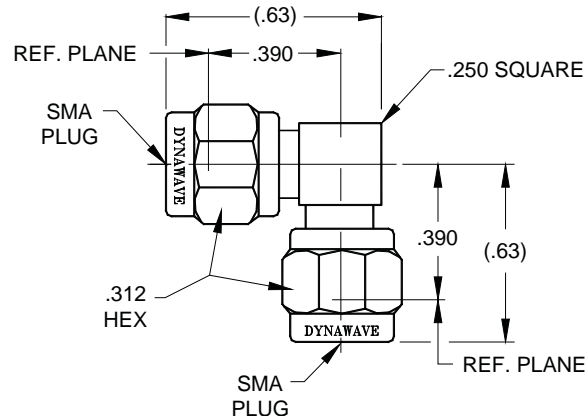

PART NUMBER	MATERIAL TYPE	FREQUENCY RANGE
1101-9898-6239	STAINLESS STEEL	DC - 18.0 GHz.

Specifications are subject to change without notice

sma • in-series adapters

female, jack to female, jack, bulkhead mount

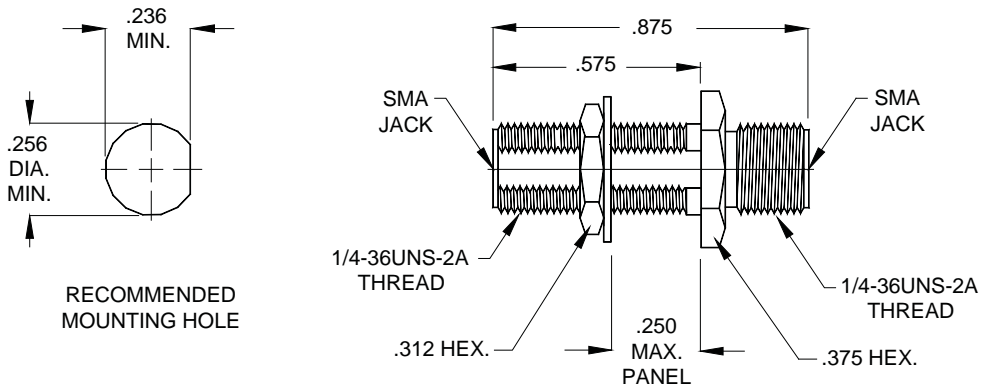

PART NUMBER	MATERIAL TYPE	FREQUENCY RANGE
1110-9999-2400	BRASS	DC - 18.0 GHz.
1110-9999-6201	STAINLESS STEEL	DC - 18.0 GHz.

sma • in-series hermetic adapters

female, jack to female, jack, bulkhead mount

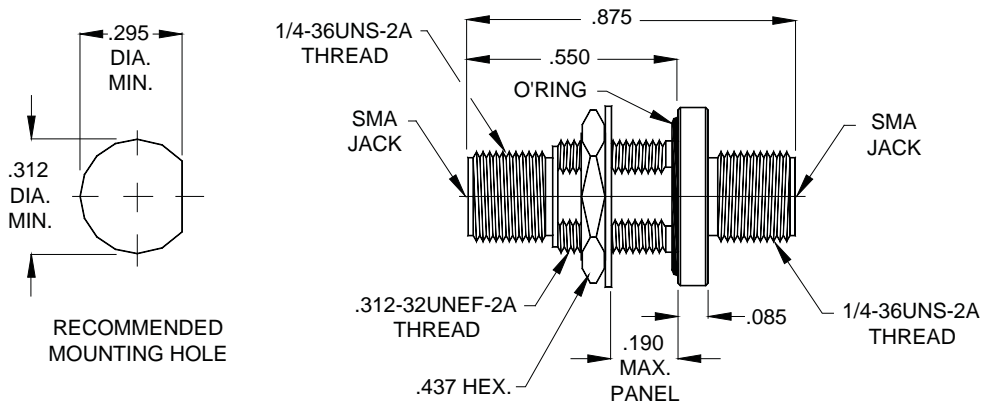

PART NUMBER	MATERIAL TYPE	FREQUENCY RANGE
1120-9999-6400	STAINLESS STEEL	DC - 18.0 GHz.

Specifications are subject to change without notice

sma • in-series polarized adapters

female, jack to female, plug

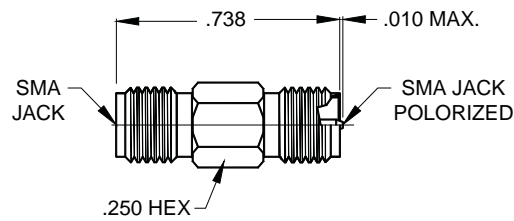

PART NUMBER	MATERIAL TYPE	FREQUENCY RANGE
1100-5999-6220	STAINLESS STEEL	DC - 26.5 GHz.

male, plug to female, plug

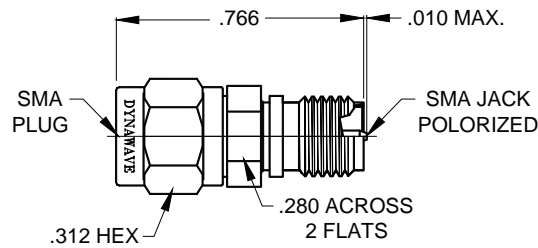

PART NUMBER	MATERIAL TYPE	FREQUENCY RANGE
1100-5998-6220	STAINLESS STEEL	DC - 26.5 GHz.

male, jack to female, jack

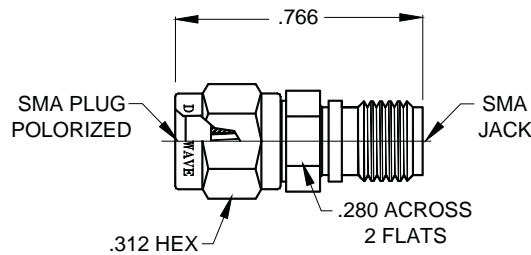

PART NUMBER	MATERIAL TYPE	FREQUENCY RANGE
1100-5899-6220	STAINLESS STEEL	DC - 26.5 GHz.

male, plug to male, jack

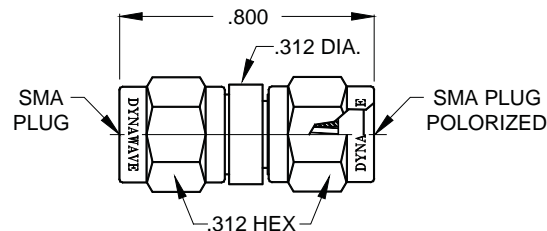

PART NUMBER	MATERIAL TYPE	FREQUENCY RANGE
1100-5898-6220	STAINLESS STEEL	DC - 26.5 GHz.

Specifications are subject to change without notice

sma • terminations

male, plug, termination

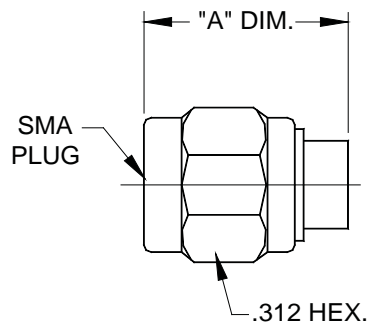

PART NUMBER	"A" DIM.	POWER	MATERIAL TYPE	FREQUENCY RANGE / VSWR MAX.
5400-9810-6251	.390 MAX.	1.0 W	STAINLESS STEEL	DC - 18.0 GHz. / 1.20 : 1
5400-9810-6250	.440/380	1.0 KW	STAINLESS STEEL	DC - 2.5 GHz. / 1.15 : 1

sma ● semi rigid, hi-voltage cable connectors

straight cable, male, plug, direct solder

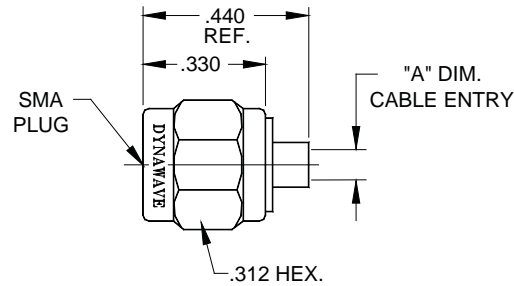

PART NUMBER	"A" DIA.	CABLE TYPE	MATERIAL TYPE	FREQUENCY RANGE
5800-4126-6401	.144 MIN.	RG 402/U (.141)	STAINLESS STEEL	DC - 4.0 GHz.

straight cable, male, plug, anti-torque, direct solder

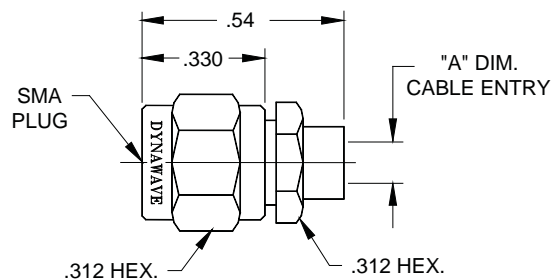

PART NUMBER	"A" DIA.	CABLE TYPE	MATERIAL TYPE	FREQUENCY RANGE
5800-4126-6400	.144 MIN.	RG 402/U (.141)	STAINLESS STEEL	DC - 4.0 GHz.

Specifications are subject to change without notice

sma • straight terminal, high voltage

female, jack, 2 hole flange mount

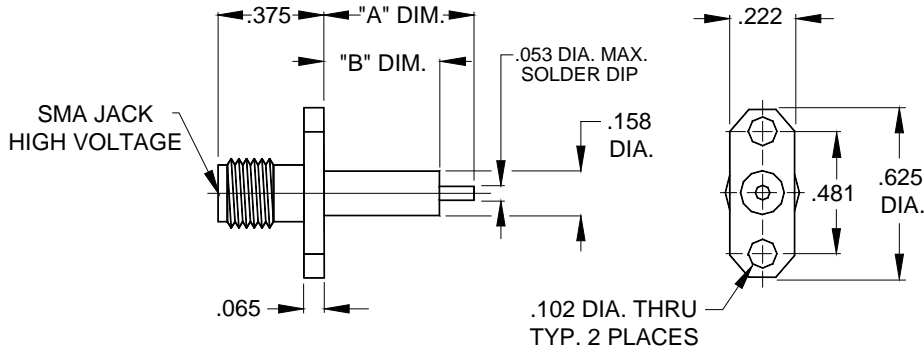

PART NUMBER	"A" DIM.	"B" DIM.	MATERIAL TYPE	FREQUENCY RANGE
5952-0031-6483	.198 / .178	.115 / .095	STAINLESS STEEL	DC - 4.0 GHz.
5952-0031-6484	.245 / .225	.180 / .160	STAINLESS STEEL	DC - 4.0 GHz.
5952-0031-6485	.650 / .630	.600 / .580	STAINLESS STEEL	DC - 4.0 GHz.

sma • right angle, surface launch

female, jack, right angle, surface launch

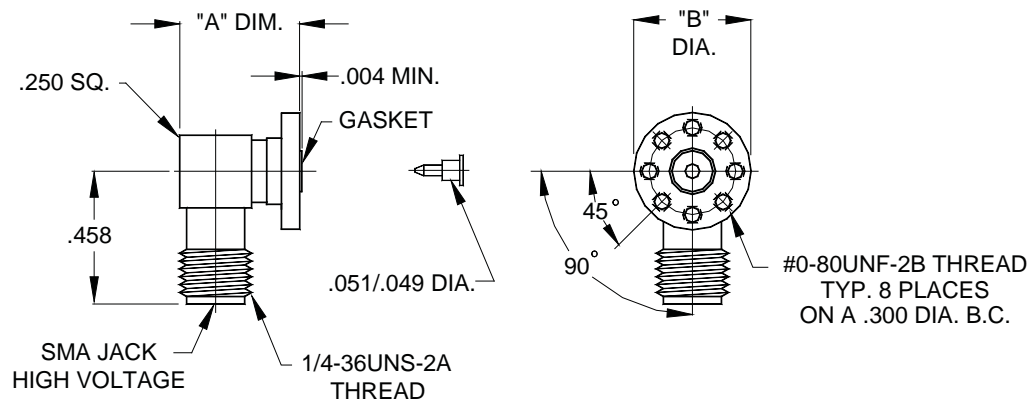

PART NUMBER	"A" DIM.	"B" DIM.	MATERIAL TYPE	FREQUENCY RANGE
5981-0381-6441	.415 MAX.	.406 DIA.	STAINLESS STEEL	DC - 4.0 GHz.