

## High Frequency, High Power Capacitors for Induction Heating

### APPLICATION:

High Energy's CH type capacitors are specifically designed for use in very high power, high frequency circuits. They are primarily used in induction heating applications as the resonant capacitors for the load.

Our CH type capacitors are an economical and efficient replacement for power mica type capacitors.

### CONSTRUCTION:

Type CH capacitors utilize metallized polypropylene dielectric technology for self healing capability and very low dielectric losses. The design of the CH series capacitors maximizes current carrying ability and heat transfer to the busbar.

### MOUNTING:

There are a variety of mounting options available, including **Metric or English** threads, and additional holes to allow series stacking of capacitors. Contact plates are silver plated copper.

### SPECIFICATIONS:

To utilize these capacitors at full rated power, they must be mounted on water cooled busbars. The minimum cooling required is 250 ml/min. of water to each side of the capacitor. The water exit temperature must be less than 45° C.

### Typical Ratings\*:

Part #	Mfd	Voltage	Fig.
CHE6020M	.20	600	1
CHE6040M	.40	600	1
CHE6065M	.65	600	1
CHE6100M	1.00	600	1
CHE6150M	1.50	550	1
CHE6200M	2.00	450	1
CHD6010A	.10	600	2
CHD6020A	.20	600	2
CHD6050A	.50	500	2
CHF6033M	.33	600	3
CHF6066M	.66	600	3
CHG6010	.10	600	4
CHG6020	.20	600	4

\*Other values are available, contact the factory. Metric dimensions and threads are available.

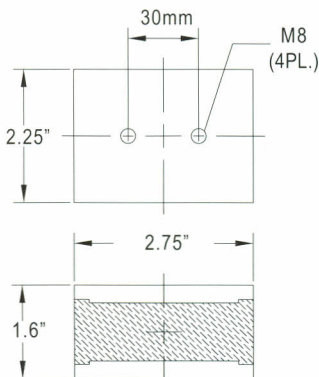
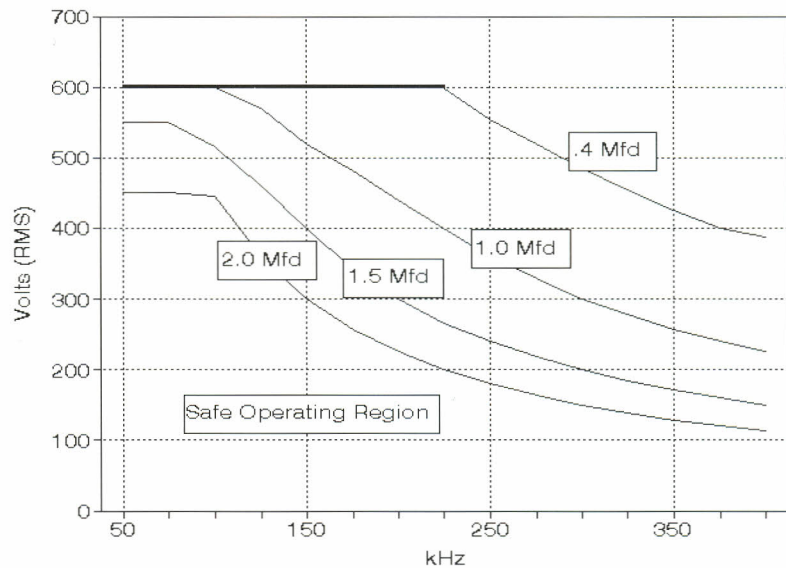

Fig. 1

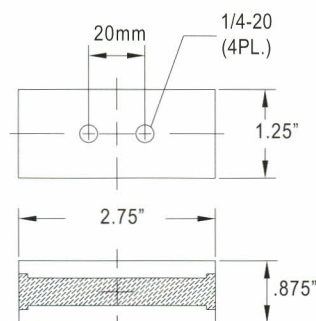

Fig. 2

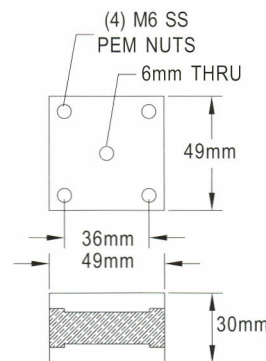

Fig. 3

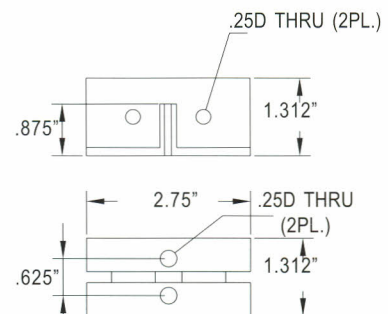

Fig. 4