

Specification	
Capacity C_{max} (nominal)	1300pF
Capacity C_{min} (nominal)	40pF
Voltage (Peak Test U_{pt} /Peak Working U_{pw})	50kV/30kV
Capacity tolerance (liner Range)	2%
Max. Current I_{max} at 13.56MHz with	797Arms
Water Cooling	25L/min
Capacitance per turn	35.6pF/turn
Torque	$\leq 1.5Nm$
Net Weight	20kg

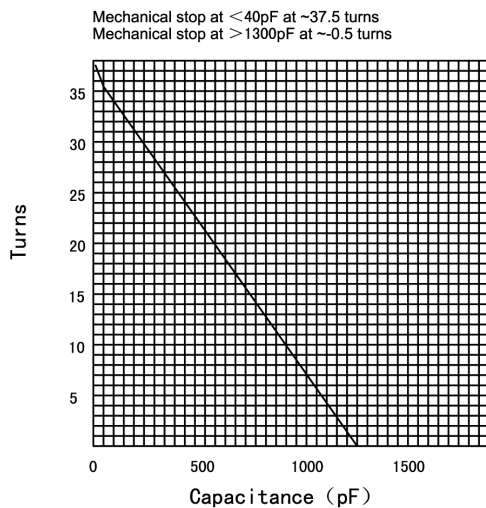

I_{max} for 25L/min Water cooling; max. temperature at inlet 70°C max
 Fix end has to be cooled with min. 50W

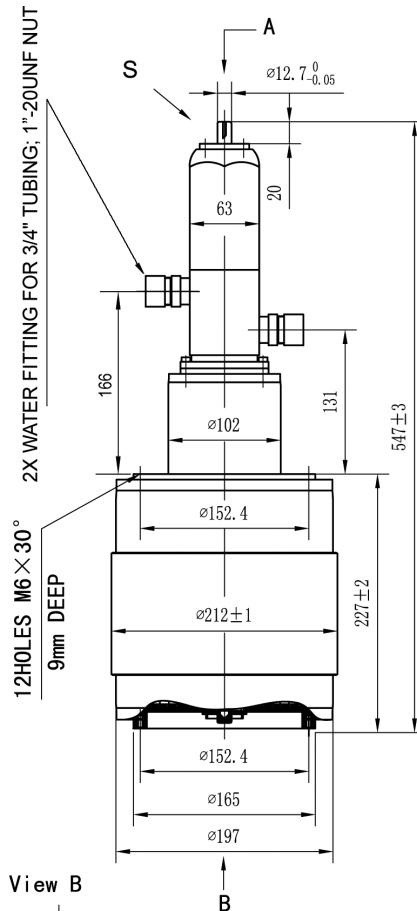
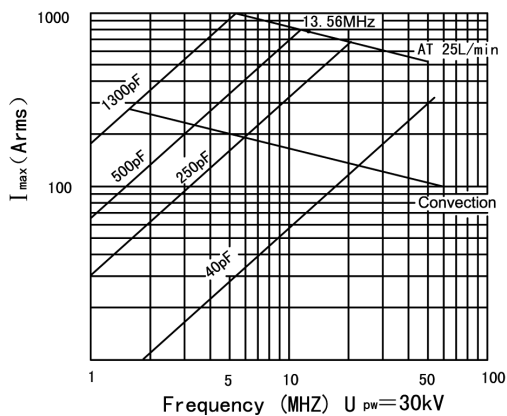

View B

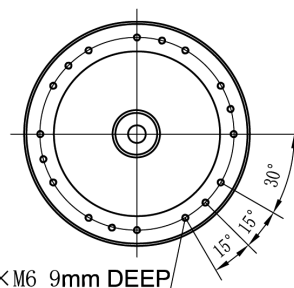

18xM6 9mm DEEP

View S

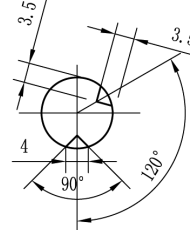

View A

